

GRACE CROSSING

GRACE CROSSING BAPTIST CHURCH - PHASE 1A EXPANSION

598 Yandell Rd, Canton, MS 39046

CDFL PROJECT NUMBER: 18-108

SITE PLAN REVIEW

NOVEMBER 16TH, 2020



cdf.com
601.366.3110
3221 Old Canton Rd
Suite 200
Jackson, MS
39216

PROJECT NUMBER
18-108
DATE
11/16/20
DRAWN BY
RF

REVISIONS	NO.	DATE

Grace Crossing Baptist Church
Expansion
598 Yandell Rd, Canton, MS
39046
Grace Crossing Baptist
Church

**NOT FOR
CONSTRUCTION
SITE PLAN
REVIEW**

COVER SHEET

G-001

CIVIL GENERAL NOTES

GENERAL NOTES:

- THE CONTRACTOR SHALL FURNISH THE ENGINEER WITH TWO SETS OF "AS-BUILT" DRAWINGS PRIOR TO REQUESTING A FINAL INSPECTION. THE "AS-BUILT" DRAWINGS SHALL SHOW THE LOCATIONS OF ALL SEWER AND WATER STRUCTURES, LINES, BENDS, AND APPURTENANCES. GRADES ON STORM SEWER LINES SHALL ALSO BE FURNISHED ON "AS-BUILTS" DRAWINGS.
- INSTALLATION OF ANY GRAVITY FLOW PIPE, SUCH AS SANITARY SEWER OR STORM DRAIN, SHALL REQUIRE THAT THE CONTRACTOR START AT THE LOWEST CONNECTION POINT ELEVATION, AND WORK IN THE UPHILL DIRECTION. IF, IN THE BEST INTEREST OF THE PROJECT, THE CONTRACTOR WISHES TO INITIATE PIPE LAYING AT SOME LOCATION OTHER THAN THE LOWEST CONTROL, IT SHALL BE THE CONTRACTOR'S RESPONSIBILITY TO CONFIRM A SATISFACTORY CONNECTION TO THE LOWEST CONTROL, PRIOR TO BEGINNING CONSTRUCTION AT SOME POINT OTHER THAN THE LOWEST CONTROL ELEVATION. THE CONTRACTOR SHALL REQUEST, IN WRITING, AND RECEIVE, IN WRITING, APPROVAL FROM THE DESIGN ENGINEER, WHOSE NAME APPEARS ON THESE PLANS. SANITARY SEWER MAINS OR SERVICES WITH LESS THAN THREE FEET OF COVER SHALL BE DUCTILE IRON PIPE. WHEREVER A SANITARY SEWER SERVICE CROSSES OVER OR UNDER A STORM DRAIN PIPE AND/OR A WATER MAIN, THE SERVICE SHALL BE EXTENDED A MINIMUM OF FIVE FEET BEYOND THE FURTHEST PIPELINE. IN NO CASE, WITHOUT THE ENGINEERS WRITTEN APPROVAL, SHALL THE CONTRACTOR TERMINATE THE SANITARY SEWER SERVICE AT A LOCATION THAT WOULD REQUIRE THE BUILDING PLUMBER TO INSTALL PIPE ACROSS THE STORM DRAIN PIPE AND/OR WATER MAIN.
- CONTRACTOR SHALL PROVIDE ADEQUATE PROTECTION TO PREVENT DAMAGE TO ALL TREE ROOTS DURING ENTRENCHING AND ANY OTHER CONSTRUCTION THAT MAY ENDANGER THE HEALTH OF THE TREES.
- UNLESS NOTED OTHERWISE, THE CONTRACTOR SHALL BE RESPONSIBLE FOR REPAIRING ANY DAMAGE DONE TO ANY EXISTING ON-SITE OR OFF-SITE ITEMS THAT WILL REMAIN IN PLACE AFTER CONSTRUCTION ACTIVITIES ARE COMPLETE. THOSE ITEMS INCLUDE, BUT ARE NOT LIMITED TO DRAINAGE SYSTEMS, UTILITIES, CURBING, PAVEMENT, LANDSCAPING, IRRIGATION SYSTEMS, FENCING, SITE STRUCTURES, RETAINING WALLS, ETC. REPAIRS SHALL BE EQUAL TO OR BETTER THAN EXISTING CONDITIONS, AND SHALL BE TO THE SATISFACTION OF THE OWNER OF THE REPAIRED ITEM. PRIOR TO MAKING ANY REPAIRS, THE CONTRACTOR SHALL SUBMIT A DETAILED REPAIR METHODOLOGY TO THE ENGINEER AND ARCHITECT. REPAIRS SHALL NOT BEGIN UNTIL APPROVAL FROM THE ENGINEER AND ARCHITECT HAS BEEN ISSUED. CONTRACTOR SHALL DOCUMENT ANY EXISTING DAMAGE WITH PHOTOS, VIDEOS, ETC., AND NOTIFY THE ARCHITECT AND ENGINEER PRIOR TO COMMENCING CONSTRUCTION IN THE AREA OF THE EXISTING DAMAGED ITEM.

CONTRACTOR RESPONSIBILITY NOTES:

- THE PROPOSED WORK ITEMS SHOWN ON THESE PLANS DO NOT NECESSARILY DEPICT ANY AND ALL ITEMS THAT MAY BE REQUIRED TO IMPLEMENT A FINAL BEST MANAGEMENT PRACTICES STORMWATER POLLUTION PREVENTION PLAN. THESE WORK ITEMS DO NOT RELIEVE THE CONTRACTOR OF ENSURING THAT ALL LOCAL, STATE AND FEDERAL REQUIREMENTS FOR STORM WATER POLLUTION PREVENTION, WATER QUALITY AND ILLEGAL POINT SOURCE DISCHARGE ARE STRICTLY ADHERED TO. THE CONTRACTOR SHALL BE RESPONSIBLE FOR ANY AND ALL ACTIONS THAT ARE NECESSARY TO BE IN COMPLIANCE WITH ALL OF THESE REGULATIONS. THE CONTRACTOR SHALL BEAR ALL EXPENSES RELATED TO IMPLEMENTING THESE MEASURES AND A PROPER BEST MANAGEMENT PRACTICES STORMWATER POLLUTION PREVENTION PLAN IRRESPECTIVE OF WHETHER A REQUIRED FACILITY, STRUCTURE, FENCING, SEEDING, MATS, ETC. ARE SHOWN ON THESE PLANS.
- THE CONTRACTOR SHALL BE RESPONSIBLE FOR READING AND IMPLEMENTING ALL NOTES SHOWN IN THESE PLANS. THE CONTRACTOR SHALL NOT BE RELIEVED OF ANY REQUIREMENTS SET FORTH AS PART OF NOTES SHOWN ON THIS SHEET OR ANY ADDITIONAL COSTS THAT MAY BE INCURRED FOR FAILURE TO READ SAID NOTES.

EROSION CONTROL NOTES:

- EROSION CONTROL MEASURES SHALL BE INSTALLED PROMPTLY DURING ALL CONSTRUCTION PHASES. ALL EROSION CONTROL MEASURES SHALL BE IN ACCORDANCE WITH THE MISSISSIPPI PLANNING AND DESIGN MANUAL FOR THE CONTROL OF EROSION, SEDIMENT AND STORMWATER. INSTALLATION AND MAINTENANCE OF STRUCTURAL AND VEGETATIVE PRACTICES SHALL BE PER THE MISSISSIPPI DEPARTMENT OF ENVIRONMENTAL QUALITY, FIELD MANUAL FOR EROSION AND SEDIMENT CONTROL ON CONSTRUCTION SITES IN MISSISSIPPI, SECOND EDITION 2005. IN ADDITION, CONTRACTOR SHALL COMPLY WITH ALL LOCAL, STATE AND FEDERAL REQUIREMENTS.
- CONTRACTOR SHALL COMPLY WITH ALL MDEQ AND OWNER REQUIREMENTS. PROJECT SUPERINTENDENT AND OTHERS PERFORMING WORK RELATED TO CONSTRUCTION STORMWATER MANAGEMENT SHALL ATTEND ANY LOCAL TRAINING PERTAINING TO EROSION CONTROL IF REQUIRED BY THE OWNER.

DEMOLITION NOTES:

- CONTRACTOR SHALL REFERENCE THE GEOTECHNICAL INVESTIGATION REPORT ATTACHED WITH THE PROJECT MANUAL AND SHALL FAMILIARIZE HIMSELF WITH ALL OBSERVATIONS, RECOMMENDATIONS, AND DATA CONTAINED IN THAT INVESTIGATION PRIOR TO ANY DISTURBANCE TO THE PROJECT AREA.
- CONTRACTOR SHALL REMOVE EXISTING ASPHALT, PCC CONCRETE, CURB AND GUTTER, ETC. AS REQUIRED TO INSTALL NEW IMPROVEMENTS. CONTRACTOR SHALL BE RESPONSIBLE FOR REMOVAL AND DISPOSAL OF ANY AND ALL DEBRIS RELATED TO DEMOLITION. CONTRACTOR SHALL INCLUDE, IN HIS BASE BID, ALL COSTS REQUIRED TO DEMOLISH AND REPLACE ANY ITEMS REQUIRED TO INSTALL THE NEW IMPROVEMENTS SHOWN IN THE CONSTRUCTION DOCUMENTS.
- CONTRACTOR SHALL REMOVE ANY EXISTING SIGNAGE WITHIN THE LIMITS OF DISTURBANCE TO PREVENT DAMAGE DURING CONSTRUCTION.

SITE NOTES:

- CONTRACTOR SHALL BE RESPONSIBLE FOR OBTAINING ALL PERMITS FOR THIS PROJECT PRIOR TO COMMENCEMENT OF ANY CONSTRUCTION OR DEMOLITION.
- CONTRACTOR SHALL INSTALL ISOLATION JOINTS BETWEEN THE SIDEWALKS AND OTHER FIXED STRUCTURES.
- CONTRACTOR SHALL BE RESPONSIBLE FOR COORDINATING WITH ANY AND ALL UTILITY COMPANIES IN REGARDS TO UTILITIES THAT MAY NEED TO BE RELOCATED AS PART OF THIS WORK.
- CONTRACTOR SHALL PROVIDE PROPER TRAFFIC CONTROL WARNING SIGNS THROUGH THE DURATION OF THE PROJECT AS REQUIRED BY THE ENGINEER OF RECORD AND AUTHORITIES HAVING JURISDICTION. ALL SIGNAGE SHALL BE IN ACCORDANCE WITH THE "MANUAL ON UNIFORM TRAFFIC CONTROL DEVICES" (MUTCD), LATEST EDITION.
- IF TRAFFIC INTERRUPTIONS ARE REQUIRED, THEY SHALL BE KEPT TO A MINIMUM AND THE CONTRACTOR SHALL BE SUBJECT TO LOCAL LAWS IN REGARDS TO TRAFFIC INTERRUPTIONS.
- CONTRACTOR SHALL KEEP ALL OTHER ROADS OPERATIONAL THROUGHOUT THE COURSE OF THE PROJECT. HOWEVER, IN THE EVENT ROAD CLOSURE IS NECESSARY, CONTRACTOR SHALL NOTIFY ALL AGENCIES AT LEAST SEVENTY-TWO (72) HOURS IN ADVANCE OF ANY ROAD CLOSINGS. THIS NOTIFICATION SHALL INCLUDE, BUT NOT BE LIMITED TO, POLICE, FIRE AND OWNER ALONG WITH ALL REGULATORY AND GOVERNMENTAL AGENCIES. IF TRAFFIC INTERRUPTIONS ARE REQUIRED, THEY SHALL BE KEPT TO A MINIMUM AND THE CONTRACTOR SHALL BE SUBJECT TO LOCAL LAWS IN REGARDS TO TRAFFIC INTERRUPTIONS.
- CONTRACTOR SHALL INSTALL HANDICAP PARKING, SYMBOLS AND RAMPS PER CITY OF CANTON AND A.D.A. REQUIREMENTS.
- CONTRACTOR SHALL STRIPE ALL HANDICAP PARKING SPACE BLUE. ALL OTHER STRIPING SHALL BE WHITE, U.N.D.
- CONTRACTOR SHALL BE RESPONSIBLE FOR VERIFYING ALL DIMENSIONS AS SHOWN ON THE SITE LAYOUT PLAN. ANY DISCREPANCIES SHALL BE BROUGHT TO THE IMMEDIATE ATTENTION OF THE ENGINEER. CONTRACTOR SHALL CONSULT AND VERIFY ALL BUILDING DIMENSIONS WITH THE BUILDING PLANS AND THE FOUNDATION PLANS. IF ANY DISCREPANCIES ARISE, THE BUILDING PLANS AND/OR THE FOUNDATION PLAN OVERRIDE ANY DIMENSIONS ON THE SITE LAYOUT PLAN. CONTRACTOR SHALL BE RESPONSIBLE FOR NOTIFYING ENGINEER IF ANY SAID DISCREPANCIES MAY AFFECT THE LAYOUT OF THE SITE PLAN.
- PROPERTY LINE AND OTHER SITE FEATURES ARE BASED ON PREVIOUS SURVEYS AND PROJECTS. THEY SHOULD BE TAKEN AS APPROXIMATE AND CONTRACTOR SHOULD LOCATE THE TRUE PROPERTY BOUNDARY WHERE WORKING NEAR THE PROPERTY LINES.

SITE GRADING & DRAINAGE NOTES:

- ALL TOPOGRAPHIC INFORMATION INCLUDING, BUT NOT LIMITED TO, LOCATIONS OF ALL EXISTING ABOVE AND BELOW GROUND UTILITIES, EXISTING SANITARY SEWER INVERT INFORMATION, TREES, AND EXISTING ROADWAYS WERE TAKEN FROM A TOPOGRAPHIC SURVEY PERFORMED BY FLOYD & BAIRD ENGINEERING, INC. IF THE CONTRACTOR DOES NOT ACCEPT THE EXISTING TOPOGRAPHY AS SHOWN ON THESE PLANS, WITHOUT EXCEPTION, HE SHALL HAVE MADE, AT HIS EXPENSE, A TOPOGRAPHIC SURVEY BY A REGISTERED LAND SURVEYOR AND SUBMIT IT TO THE OWNER AND THE ENGINEER OF RECORD FOR REVIEW.
- THE CONTRACTOR IS SPECIFICALLY CAUTIONED THAT THE LOCATION AND/OR ELEVATION OF EXISTING UTILITIES AS SHOWN ON THESE PLANS IS BASED ON THE PROVIDED SURVEY, RECORDS OF THE VARIOUS UTILITY COMPANIES, EXISTING AS-BUILT DRAWINGS, AND CONVERSATIONS WITH THE OWNER. THE INFORMATION IS NOT TO BE RELIED ON AS BEING EXACT OR COMPLETE. THE CONTRACTOR MUST CALL THE APPROPRIATE UTILITY COMPANY AT LEAST 72 HOURS BEFORE ANY EXCAVATION TO REQUEST EXACT FIELD LOCATION OF UTILITIES. IT SHALL BE THE CONTRACTOR'S RESPONSIBILITY TO RELOCATE ALL EXISTING UTILITIES WHICH CONFLICT WITH THE PROPOSED IMPROVEMENTS SHOWN ON THE PLANS.
- CONTRACTOR SHALL BE RESPONSIBLE FOR VERIFYING HORIZONTAL AND VERTICAL LOCATIONS OF ALL EXISTING STORM SEWER STRUCTURES, PIPES, ETC., AND ALL UTILITIES PRIOR TO CONSTRUCTION.
- CLEARING AND GRUBBING LIMITS SHALL INCLUDE ALL AREAS DISTURBED BY GRADING OPERATIONS. CONTRACTOR IS RESPONSIBLE FOR THE PROTECTION OF ALL UNDISTURBED AREAS, ALL PROPERTY CORNERS AND REPLACING ALL PINS AND SURVEY BENCHMARKS ELIMINATED OR DAMAGED DURING CONSTRUCTION.
- CONTRACTOR SHALL BE RESPONSIBLE FOR FAMILIARIZING HIMSELF WITH ALL LOCAL GOVERNING CODES AND SHALL COMPLY WITH SAID CODES.
- ALL PIPE SHALL BE INSTALLED IN ACCORDANCE WITH THE MANUFACTURER'S RECOMMENDATIONS.
- ANY DRAINAGE STRUCTURE, CURB INLET, OR CATCH BASIN WITH A DEPTH GREATER THAN FOUR FEET ARE REQUIRED TO HAVE STEPS.
- ALL FINISHED GRADES SHOWN IN ROADWAY/PARKING ARE TOP OF PAVEMENT UNLESS OTHERWISE NOTED.

UTILITY NOTES:

- CONTRACTOR SHALL BE RESPONSIBLE FOR VERIFYING LOCATIONS OF ALL PROJECT RELATED UTILITIES, BURIED AND ABOVE GROUND, REGARDLESS OF INCLUSION ON THESE PLANS. THE LOCATIONS OF ANY EXISTING UTILITIES SHOWN ARE APPROXIMATE ONLY. THE CONTRACTOR SHALL BE RESPONSIBLE FOR DETERMINING THE EXACT LOCATIONS OF ALL EXISTING UTILITIES BEFORE COMMENCING WORK. ALL CONTRACTOR DAMAGED UTILITIES SHALL BE REPAIRED AT THE CONTRACTOR'S EXPENSE.
- CONTRACTOR SHALL BE RESPONSIBLE FOR COORDINATING WITH OTHER TRADES FOR TIE IN LOCATION AND SIZE/FLOW REQUIREMENTS FOR WATER AND SEWER TIE IN. TIE IN LOCATIONS AND SIZES ARE SUBJECT TO CHANGE BASED ON ARCHITECTURAL AND PLUMBING PLANS.
- ALL UTILITIES SHALL REMAIN OPERATIONAL THROUGHOUT THE DURATION OF THE PROJECT. THE CONTRACTOR SHALL NOTIFY THE OWNER AND UTILITY COMPANY OF ANY TEMPORARY UTILITY INTERRUPTION OR ANY CONSTRUCTION HAVING POTENTIAL IMPACT TO THE UTILITY'S STRUCTURE AT A MINIMUM 48 HOURS PRIOR TO COMMENCING WORK.
- WATER SERVICE SHALL BE MAINTAINED TO ALL EXISTING CUSTOMERS; IF ANY SERVICE MUST BE INTERRUPTED, THE CONTRACTOR MUST CONTACT THE UTILITY COMPANY AND OWNER, AND THE AFFECTED CUSTOMERS SHALL BE NOTIFIED AT LEAST 48 HOURS IN ADVANCE BY THE CONTRACTOR.
- CONTRACTOR SHALL PROVIDE A COVER OF 36", MINIMUM, ON ALL WATER MAINS.
- NEW WATER MAIN SHALL MAINTAIN 18" VERTICAL SEPARATION AND 10' HORIZONTAL SEPARATION BETWEEN SEWER MAIN AND STORM DRAIN PIPES, WHERE CROSSINGS OCCUR. WATER MAIN SHALL BE ROUTED OVER STORM PIPE WHEREVER POSSIBLE.
- CONTRACTOR SHALL INSTALL THRUST BLOCKS AT ALL BENDS AND FITTINGS (SEE DETAIL SHEET).
- CONTRACTOR SHALL INSTALL LOCATOR WIRE AROUND ALL NEW INSTALLED PIPE AND FITTINGS.
- ALL PROPOSED POTABLE WATER LINE FITTINGS, FIRE HYDRANTS AND ALL OTHER WATER LINE PIPING MATERIALS AND FITTINGS FOR THIS PROJECT SHALL BE AWWA APPROVED.
- CONTRACTOR SHALL INSTALL ALL WATER LINES AND FITTINGS AS PER MANUFACTURER'S INSTALLATION RECOMMENDATIONS.
- CONTRACTOR SHALL BE RESPONSIBLE FOR COORDINATING WITH BUILDING CONTRACTOR FOR LOCATION OF ALL UTILITY ENTRANCES AND CONNECTIONS.
- EXISTING WATER, GAS, AND SANITARY SERVICE LINES SHOWN ARE APPROXIMATE LOCATIONS ONLY. CONTRACTOR SHALL BE RESPONSIBLE FOR HAVING THESE LINES LOCATED AND COORDINATE TIE IN LOCATIONS WITH THE BUILDING CONTRACTOR.
- CONTRACTOR SHALL BE RESPONSIBLE FOR VERIFYING THE EXISTING BUILDING SANITARY SEWER PIPE ELEVATION AND DETERMINE THE ELEVATION REQUIRED TO CONNECT TO THE EXISTING SEWER LINES.
- CONTRACTOR SHALL BE RESPONSIBLE FOR INSTALLING ALL SEWER LINES TO INSURE POSITIVE FLOW OF SEWER LINES.
- THESE PLANS ARE SUBJECT TO APPROVAL BY THE LOCAL GOVERNING MUNICIPALITY AND ANY OTHER GOVERNING AUTHORITY.
- SITE CONTRACTOR SHALL BE RESPONSIBLE FOR STUB OUT OF ALL UTILITIES TO WITHIN 4' OF THE BUILDING AT THE REQUIRED LOCATION AS DIRECTED BY THE PLUMBING CONTRACTOR. SITE CONTRACTOR SHALL COORDINATE LOCATION AND STUB OUT REQUIREMENTS PER ARCHITECTURAL/PLUMBING/ELECTRICAL, ETC. PRIOR TO COMMENCEMENT OF CONSTRUCTION.
- CONTRACTOR SHALL COORDINATE WITH ATMOS ENERGY FOR ALL REQUIREMENTS DURING AND POST CONSTRUCTION FOR WORK AROUND THE EXISTING GAS LINES ON THE SITE. COORDINATION WITH ATMOS SHALL BE PERFORMED PRIOR TO COMMENCING CONSTRUCTION ACTIVITIES. ALL COSTS RELATED TO ATMOS REQUIREMENTS REGARDING THE EXISTING GAS MAINS ON CAMPUS SHALL BE INCLUDED IN THE CONTRACTOR'S BASE BID.
- THE CONTRACTOR SHALL COORDINATE THESE PLANS TO ENSURE CURRENT INFRASTRUCTURE IS IN PLACE TO PROVIDE SERVICE AS SHOWN ON THESE PLANS. IF ANY ADDITIONAL WORK TO THE EXISTING INFRASTRUCTURE IS REQUIRED TO PROVIDE GAS OR WATER SERVICE AS SHOWN, THE CONTRACTOR SHALL COORDINATE THAT WORK WITH THE OWNER PRIOR TO COMMENCING CONSTRUCTION.

SHEET LIST	
SHEET	DESCRIPTION
C001	CIVIL GENERAL NOTES
C101	EROSION CONTROL PLAN
C111	DEMOLITION PLAN
C121	SITE PLAN
C131	GRADING PLAN
C141	UTILITY PLAN
C201	CIVIL DETAILS
C202	CIVIL DETAILS
C203	CIVIL DETAILS
C204	CIVIL DETAILS
C205	CIVIL DETAILS
C206	CIVIL DETAILS



cdfl.com
 601.366.3110
 3221 Old Canton Rd
 Suite 200
 Jackson, MS
 39216

PROJECT NUMBER	19072	DATE	11/13/2020	DRAWN BY	RMC
	NO.				

Grace Crossing Baptist Church
Expansion
 598 Yandell Rd, Canton, MS
 39046
 Owner

**NOT FOR
CONSTRUCTION
Permit Set**

COVER

C001



ACREAGE SUMMARY	
TOTAL PROPERTY AREA	14.99 ACRES
ON-SITE DISTURBED AREA	1.89 ACRES
OFF-SITE DISTURBED AREA	0.03 ACRES
TOTAL DISTURBED AREA	1.92 ACRES

SPECIFICATIONS REQUIREMENT:
THE REQUIREMENTS SHOWN ON THIS PLAN ARE SUPPLEMENTED BY THE SWPPP CONTAINED WITHIN THE PROJECT SPECIFICATIONS. IN CASE OF CONFLICTS BETWEEN THE PLANS, SWPPP SPECIFICATIONS AND THE ACTUAL GENERAL PERMIT, THE MOST STRINGENT REQUIREMENTS SHALL APPLY.

CAUTION NOTICE TO CONTRACTOR:
IF PROPERLY IMPLEMENTED, THIS PLAN WILL PROVIDE AN EFFECTIVE MEANS FOR CONTROLLING EROSION. HOWEVER, IT IS ACKNOWLEDGED THAT NO ONE PLAN CAN BE PREPARED THAT WILL DEPICT ALL POSSIBLE MEASURES NECESSARY FOR VARIOUS STAGES OF CONSTRUCTION. THE CONTRACTOR SHALL INCLUDE IN THE BASE BID ADEQUATE FUNDS TO PROVIDE ALL EROSION CONTROL MEASURES NECESSARY TO COMPLY WITH CODES FOR THE DURATION OF THE CONSTRUCTION PROJECT.

LIMITS OF DISTURBANCE
CONTRACTOR TO LIMIT DISTURBANCE OF SITE IN STRICT ACCORDANCE WITH THE EROSION CONTROL SEQUENCING SHOWN ON THIS PLAN. NO UNNECESSARY OR IMPROPERLY SEQUENCED CLEARING AND/OR GRADING SHALL BE PERMITTED.

100 YEAR FLOODPLAINS, FLOODWAY FRINGES, AND FLOODWAYS
- THE PROJECT IS LOCATED IN ZONE X (AREAS DETERMINED TO BE OUTSIDE THE 0.2% ANNUAL CHANCE FLOODPLAIN)

RECEIVING WATERS
- THE MAJORITY OF THE SITE DRAINS TO THE EAST VIA OVERLAND FLOW TO AN UNSIGNED TRIBUTARY OF LITTLE BEAR CREEK WHICH IS THE ULTIMATE RECEIVING WATER OF THE SITE. LITTLE BEAR CREEK IS LOCATED APPROXIMATELY 0.39 MILES TO THE EAST OF THE SITE. LITTLE BEAR CREEK IS LISTED ON THE 2018 STATE OF MISSISSIPPI 303D LIST OF IMPAIRED WATERWAYS.

SOIL TYPE
- THERE ARE THREE SOIL TYPES FOR THE PROJECT LISTED ON THE USDA NRCS SOIL SURVEY. THESE SOILS ARE AS FOLLOWS:
BRB2 BYRAM SILT LOAM ERODED
BRC2 BYRAM SILT LOAM ERODED
GRB2 GRENADA SILT LOAM ERODED

EROSION CONTROL LEGEND

- 327 --- MINOR CONTOUR, EXISTING
- 330 --- MAJOR CONTOUR, EXISTING
- LD LIMITS OF DISTURBANCE
- SF SILT FENCE
- IP1 STRAW WATTLE INLET PROTECTION
- CD ROCK CHECK DAM

- PHASE I EROSION CONTROL SEQUENCING**
1. INSTALL SILT FENCE(S) ON THE SITE (CLEAR ONLY THOSE AREAS NECESSARY TO INSTALL SILT FENCES).
 2. PREPARE TEMPORARY PARKING AND STORAGE AREA.
 3. INSTALL AND STABILIZE HYDRAULIC CONTROL STRUCTURES (SWALES, CHECK DAMS, ETC.).
 4. SEQUENCE GRADING OPERATIONS TO MINIMIZE EXPOSED AREAS.
 5. COMPLETE TOPSOIL STRIPPE AND BUILDING AREA AND ADJACENT AREAS. STOCKPILE OR HAIL OFF TOPSOIL. STABILIZE TOPSOIL STOCKPILE WITH SILT FENCES AROUND THE TOE OF SLOPES AND SEED TOPSOIL STOCKPILE.
- PHASE II EROSION CONTROL SEQUENCING**
6. TEMPORARILY SEED, THROUGHOUT CONSTRUCTION, DENuded AREAS THAT WILL BE INACTIVE FOR 14 DAYS OR MORE.
 7. INSTALL, REPLACE, REPAIR, OR MAINTAIN PERIMETER SILT FENCE, CHECK DAMS, INLET PROTECTION AND CONSTRUCTION SITS AS NEEDED.
 8. DELINEATE STOCKPILE OF UNDERCUT MATERIALS FOR BUILDING PAD AND CONSTRUCT SILT FENCE AROUND STOCKPILE.
 9. BEGIN CONSTRUCTION OF BUILDING PAD.
 10. BEGIN CONSTRUCTION OF NEW GRASSED SWALES.
 11. INSTALL UTILITIES, STORM SEWERS, CURBS AND GUTTERS.
 12. INSTALL EROSION BELLS WHILE PERFORMING UTILITY WORK IN PAVED AREAS.
 13. INSTALL RIP RAP AROUND OUTLET STRUCTURES AS EACH OUTLET STRUCTURE IS INSTALLED.
 14. INSTALL INLET PROTECTION AT ALL STORM SEWER STRUCTURES AS EACH INLET STRUCTURE IS INSTALLED.
 15. AS SOON AS STRUCTURAL LIFTS ARE COMPLETE, SPREAD TOPSOIL ON FACE OF SLOPES AND ON AREAS TO RECEIVE GRASS. PERMANENTLY STABILIZE AREAS TO BE VEGETATED AS THEY ARE BROUGHT TO FINAL GRADE.
 16. PREPARE SITE FOR PAVING.
 17. PAVE SITE.
 18. INSTALL APPROPRIATE INLET PROTECTION DEVICES FOR PAVED AREAS AS WORK PROGRESSES.
 19. COMPLETE GRADING AND INSTALLATION OF PERMANENT STABILIZATION OVER ALL AREAS.

EXISTING GRACE CROSSING CHURCH BUILDING
FFE=279.60

GRACE CROSSING BUILDING ADDITION
FFE=279.60

MATCHLINE A-A
MATCHLINE A-A



EROSION CONTROL PLAN
SCALE: 1"=20'-0"

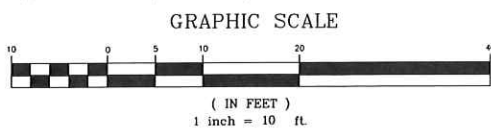

DEVELOPER/OWNER: _____
DEVELOPER/GENERAL CONTRACTOR: _____
SUPERINTENDENT: _____



EROSION CONTROL PLAN

C101

Grace Crossing Baptist Church
Expansion
588 Yandell Rd, Canton, MS
39046

Owner

NOT FOR CONSTRUCTION
Permit Set

PROJECT NUMBER
19072

DATE
11/13/2020

DRAWN BY
RMC

REVISIONS NO.	DATE

call.com
601.366.3110
3221 Old Canton Rd
Suite 200
Jackson, MS
39216

CDFEL
COOKE DOUGLASS FARR LEMONS, ARCHITECTS + ENGINEERS PA

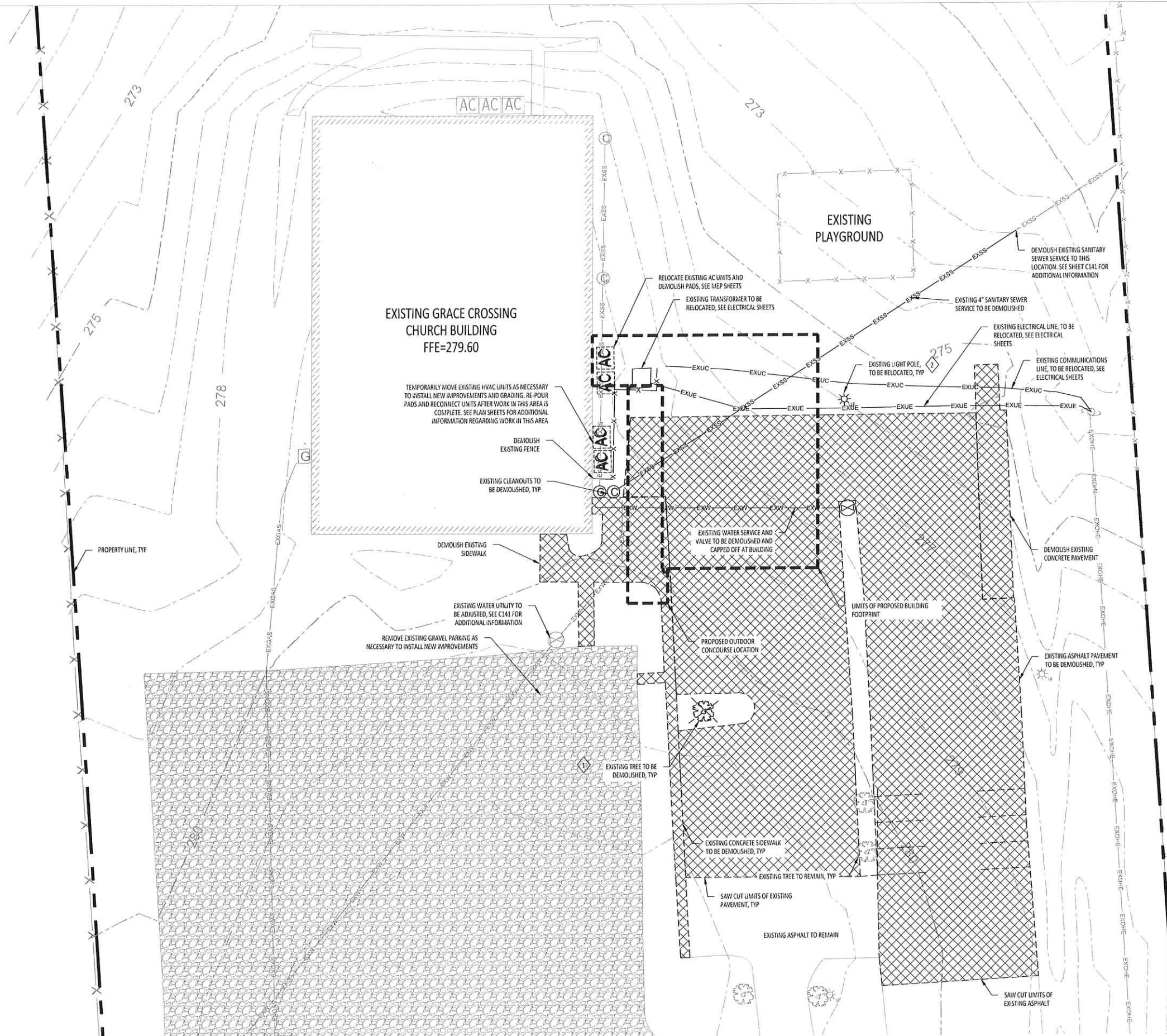

- DEMOLITION NOTES:**
- 1 EXISTING TREE AND SHRUBS WITHIN PROJECT AREA THAT ARE NOT TO REMAIN SHALL BE REMOVED AND DISPOSED OFFSITE. TREE STUMPS SHALL BE REMOVED IN THEIR ENTIRETY. GRINDING OF STUMPS IS NOT ALLOWED.
 - 2 LIGHT POLE AND BASE TO BE REMOVED. CONTRACTOR SHALL REFERENCE ELECTRICAL SHEETS, THIS SET, FOR FINAL LIGHT POLE LOCATIONS. IT IS THE CONTRACTOR'S RESPONSIBILITY TO COORDINATE WITH THE OWNER AND ARCHITECT FOR STORAGE OF LIGHT POLES. CONTRACTOR TO STORE LIGHT POLE FOR RELOCATION AFTER FINISH GRADES ARE COMPLETE.
 - 3 CONTRACTOR MUST USE CAUTION DURING DEMOLITION, PARTICULARLY IN AREAS TO RECEIVE CONCRETE OR ASPHALT DEMOLITION. ANY UTILITY, STRUCTURES, OR OTHER ITEMS DAMAGED AS A RESULT OF CONSTRUCTION ACTIVITIES SHALL BE REPLACED BY THE CONTRACTOR AT NO ADDITIONAL COST TO THE OWNER.
 - 4 THE CONTRACTOR SHALL KEEP ALL UTILITIES OPERATIONAL THROUGHOUT THE ENTIRETY OF THE PROJECT. ANY INTERRUPTION IN UTILITY SERVICE SHALL BE COORDINATED WITH THE OWNER AND AUTHORITIES HAVING JURISDICTION PRIOR TO COMMENCING CONSTRUCTION ACTIVITIES.
 - 5 IT IS THE CONTRACTOR'S RESPONSIBILITY TO PHASE CONSTRUCTION ACTIVITIES TO PROVIDE POSITIVE STORM WATER RUNOFF AT ALL TIMES. SEE STORM WATER POLLUTION PREVENTION PLAN (SWPPP) PLAN FOR ADDITIONAL INFORMATION ON EROSION CONTROL MEASURES REQUIRED.
 - 6 CONTRACTOR SHALL REFERENCE SITE, GRADING, AND UTILITY PLANS TO COORDINATE PAVEMENT AND UTILITY DEMOLITION AND CONNECTION TO PROPOSED UTILITIES, PAVEMENT, ETC. PRIOR TO COMMENCING CONSTRUCTION ACTIVITIES.
 - 7 THE CONTRACTOR SHALL COORDINATE WITH THE ARCHITECT FOR ALL ELECTRIC AND UNDERGROUND CABLE DEMOLITION AND/OR RELOCATION.
 - 8 PRIOR TO COMMENCING CONSTRUCTION, CONTRACTOR SHALL COORDINATE LOCATION AND PHASING OF DEMOLITION AND RELOCATION OF EXISTING PAVILION WATER LINE WITH THE ARCHITECT AND OWNER. EXISTING WATER LINE SIZE IS BASED ON CONVERSATIONS WITH THE OWNER.
 - 9 EXISTING PIPE TO BE REMOVED SHALL BE REMOVED IN ITS ENTIRETY.
 - 10 IN ALL AREAS WHERE THE CONTRACTOR MUST CROSS THE EXISTING ASPHALT OR GRAVEL, IT IS THE CONTRACTOR'S RESPONSIBILITY TO REPAIR THE PAVEMENT WITH A HEAVY DUTY PAVING SECTION. THE CONTRACTOR SHALL INCLUDE THE COST TO PERFORM THE PAVEMENT REPAIRS IN HIS BASE BID IF DEEMED NECESSARY.

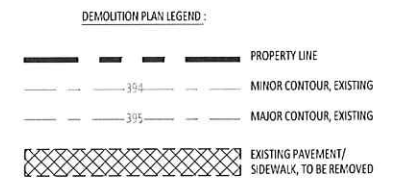

DEMOLITION PLAN
SCALE: 1"=40'-0"

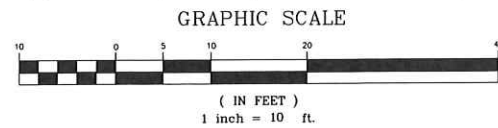

CDFEL
COOKE DOUGLASS FARR LEMONS, ARCHITECTS + ENGINEERS PA

cdell.com
601.366.3110
3221 Old Canton Rd
Suite 200
Jackson, MS
39216

PROJECT NUMBER: 19072
DATE: 11/13/2020
DRAWN BY: RMC

REVISIONS	DATE
NO.	

Grace Crossing Baptist Church
Expansion
588 Yandell Rd, Canton, MS
39046
Owner

NOT FOR CONSTRUCTION
Permit Set

DEMOLITION PLAN

C111



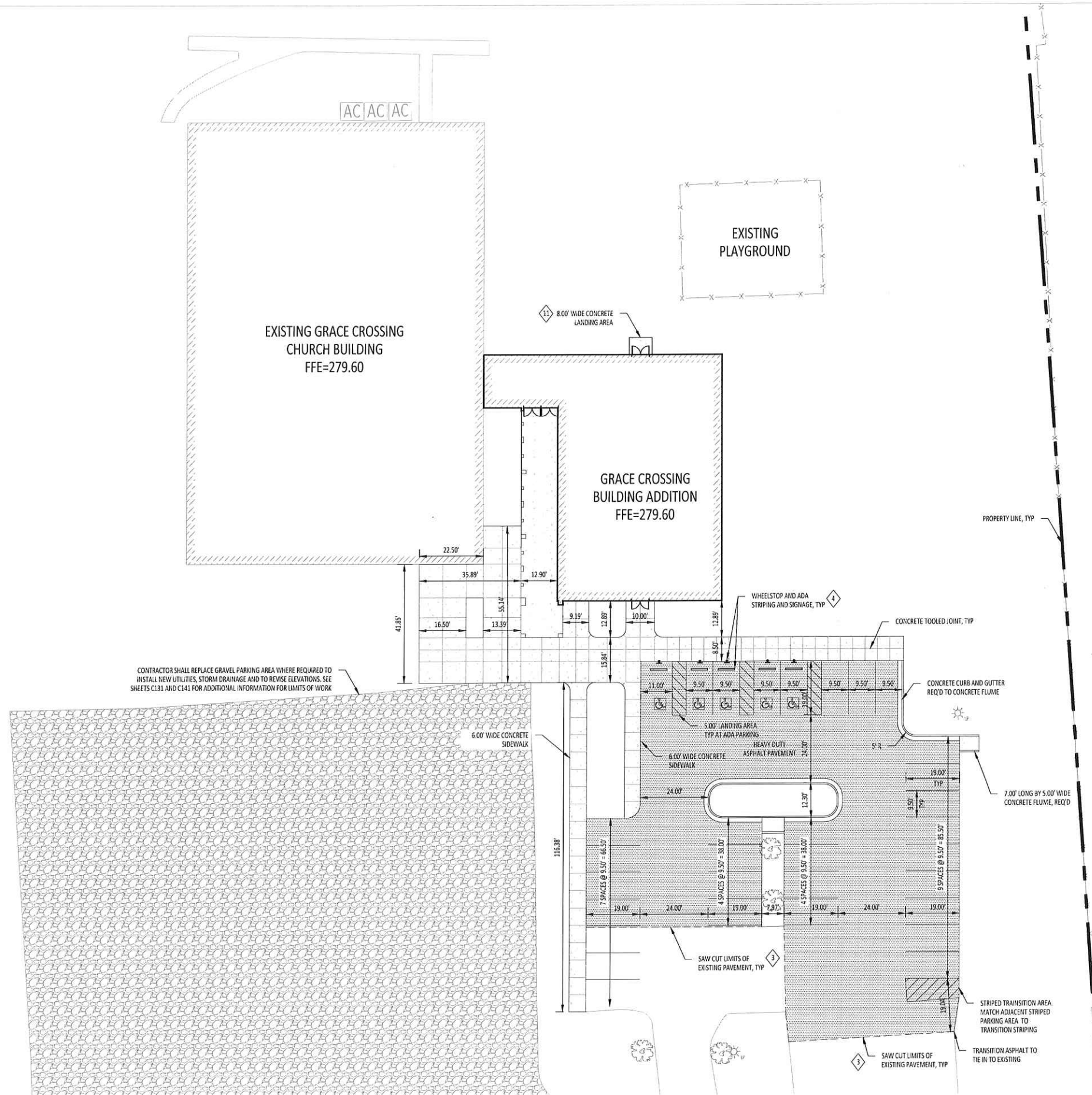

CONTRACTOR SHALL REPLACE GRAVEL PARKING AREA WHERE REQUIRED TO INSTALL NEW UTILITIES, STORM DRAINAGE AND TO REVISE ELEVATIONS. SEE SHEETS C131 AND C141 FOR ADDITIONAL INFORMATION FOR LIMITS OF WORK

- SITE PLAN NOTES:
- 1 ALL DIMENSIONS SHALL BE TO FACE OF CURB UNLESS NOTED OTHERWISE.
 - 2 ALL CURBS SHALL BE CONCRETE CURB AND GUTTER UNLESS NOTED OTHERWISE. SEE DETAIL SHEET FOR ADDITIONAL INFORMATION.
 - 3 IT IS THE CONTRACTOR'S RESPONSIBILITY TO ENSURE A SMOOTH TRANSITION BETWEEN EXISTING AND PROPOSED PAVING AREAS.
 - 4 HANDICAP PARKING AND ACCESS ROUTES SHALL MEET MADISON COUNTY AND CURRENT ADA STANDARDS.
 - 5 SIDEWALK WIDTH VARIES. CONTROL JOINTS SHALL BE PLACED EVERY 5' O.C. MIN. AND CONSTRUCTION JOINTS SHALL BE PLACED EVERY 30' O.C. MIN. REFERENCE SIDEWALK DETAIL PROJECT SPECIFICATIONS FOR ADDITIONAL INFORMATION.
 - 6 PARKING LOT STRIPES SHALL BE 4" WIDE WHITE WATERBORNE PAINT MEETING SPECIFICATION TT-P-1952B. HANDICAP PARKING STRIPING SHALL MEET MADISON COUNTY AND ADA CODE REQUIREMENTS. ALL PAVEMENT MARKINGS AND STRIPING SHALL BE PAINTED USING 2 COATS OF PAINT.
 - 7 ALL PAINTED PAVEMENT MARKINGS SUCH AS DIRECTIONAL ARROWS AND LETTERING SHALL BE PAINTED USING TEMPLATES.
 - 8 CONTRACTOR SHALL COMPLY TO ALL APPLICABLE LOCAL AND STATE CODES
 - 9 ISOLATION JOINT TYPICAL AT FIXED STRUCTURES (BUILDING, RETAINING WALLS, DRAINAGE STRUCTURES, MANHOLES, LIGHT POLE BASES, BOLLARDS, ETC.). SEE DETAIL SHEET FOR ADDITIONAL INFORMATION.
 - 10 SEE DETAIL SHEET FOR CONCRETE JOINT REQUIREMENTS.
 - 11 CONCRETE LANDING AREAS SHALL BE CONSTRUCTED WITH A 10" THICK EDGE ON ALL SIDES.
 - 12 ALL SIGNAGE AND PAVEMENT MARKINGS SHALL MEET MADISON COUNTY STANDARDS.

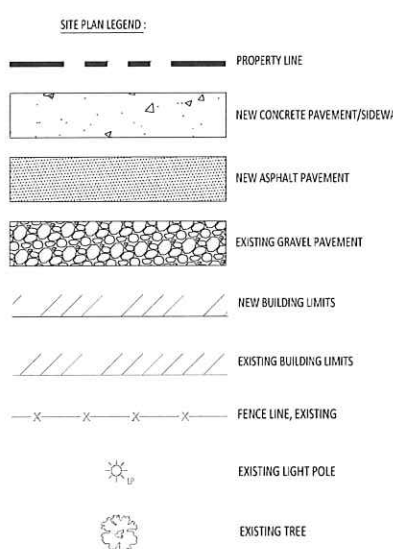

SITE PLAN
SCALE: 1"=20'-0"

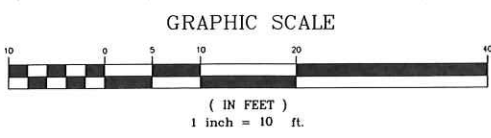

CDFL
COOKE DOUGLASS FARR LEMONS, ARCHITECTS + ENGINEERS PA

cdfl.com
601.366.3110
3221 Old Canton Rd
Suite 200
Jackson, MS
39216

PROJECT NUMBER	19072
DATE	11/13/2020
DRAWN BY	RMC
REVISIONS	
NO.	DATE

Grace Crossing Baptist Church
Expansion
598 Yandell Rd, Canton, MS
39046
Owner

NOT FOR CONSTRUCTION
Permit Set

SITE PLAN
C121



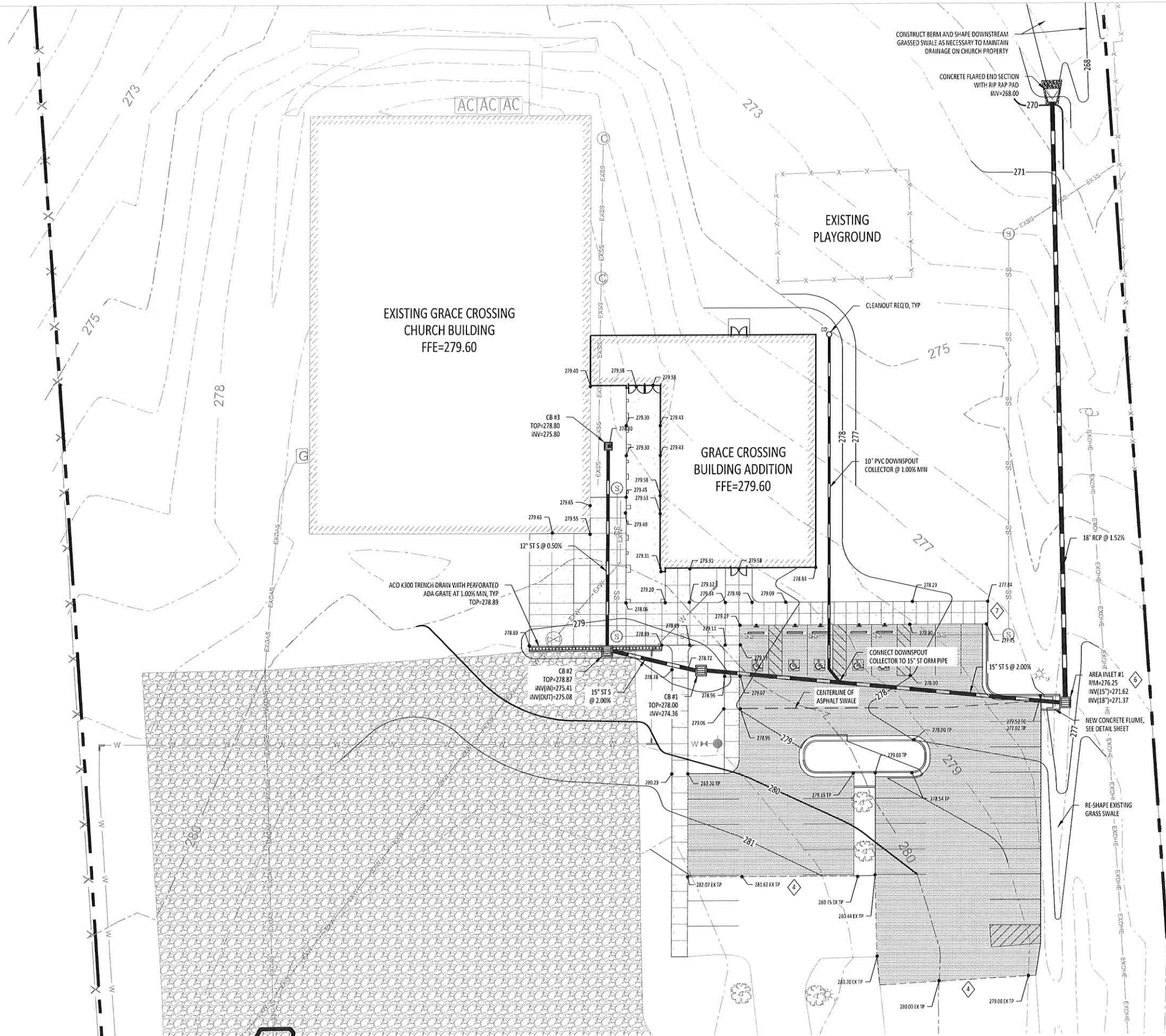

- GRADING NOTES:**
- 1 CONTRACTOR SHALL GRADE AREA AROUND NEW STORM INLETS TO ENSURE POSITIVE STORM WATER DISCHARGE FROM THE DRAINAGE AREA UPSTREAM OF THE STORM INLET.
 - 2 ALL STORM SEWER (ST S) PIPE SHALL BE CORRUGATED POLYETHYLENE (HP STORM), UNLESS NOTED OTHERWISE. ALL STORM PIPE 10" AND LESS SHALL BE SDR 26 PVC. MIN. SEE SPECIFICATIONS FOR ADDITIONAL INFORMATION.
 - 3 ALL ADA ROUTES SHALL MEET MADISON COUNTY AND ADA CODE REQUIREMENTS. LONGITUDINAL SLOPE ON ALL ADA ROUTES SHALL NOT EXCEED 1:20. TRANSVERSE SLOPES ON ALL ADA ROUTES SHALL NOT EXCEED 1:50.
 - 4 ELEVATION OF NEW EDGE OF PAVEMENT SHALL MATCH EXISTING.
 - 5 EXISTING SLOPES GREATER THAN 6:1 SHALL BE BENCHED PRIOR TO PLACING FILL.
 - 6 AREA INLET #1 SHALL BE CONSTRUCTED PER THE AREA INLET DETAIL ON THE DETAIL SHEETS.
 - 7 TRANSITION CURB FROM FLUSH TO 6" OVER 5.00'.
 - 8 CONTRACTOR SHALL REFERENCE MEP SHEETS, THIS SET, FOR ADDITIONAL INFORMATION ON INSTALLATION AND CONNECTION OF ROOF DRAINS AND RAIN LEADERS.
 - 9 CONTRACTOR SHALL BE RESPONSIBLE FOR ALL NECESSARY INSPECTIONS, APPROVALS AND/OR CERTIFICATIONS REQUIRED BY CODES AND AUTHORITIES.
 - 10 CATCH BASINS SHALL BE MDOT TYPE SS-3 WITH EAST JORDAN IRON WORKS V-5726 GRATES OR APPROVED EQUAL. CB#2 SHALL RECEIVE EAST JORDAN IRON WORKS V-5726-80 ADA STYLE GRATE. REFER TO DETAIL SHEETS FOR ADDITIONAL INFORMATION. DRAINAGE STRUCTURE, SIZE AND PIPE CONNECTION SHALL BE SIZED TO ACCOUNT FOR SKEW OF PIPE.
 - 11 CONTRACTOR SHALL ENSURE POSITIVE DRAINAGE AS SHOWN ON THIS SHEET. ANY WATER TRAPS WILL REQUIRE REMOVING AND REPLACING BY THE CONTRACTOR AT NO ADDITIONAL COST TO THE OWNER.
 - 12 THE CONTRACTOR SHALL CLOSELY FOLLOW COMPACTION REQUIREMENTS FOR OPEN TRENCHES AS DESCRIBED IN THE PROJECT SPECIFICATIONS. COMPACTION TESTING REQUIREMENTS AND REPORTS SHALL BE PROVIDED TO THE OWNER AS NOTED IN THE SPECIFICATIONS.
 - 13 EXISTING UNDERGROUND UTILITY LINES ARE SHOWN ON THE PLANS BASED UPON THE BEST INFORMATION AVAILABLE TO THE ENGINEER. THE ENGINEER CANNOT AND DOES NOT WARRANT THAT THIS INFORMATION IS COMPLETE OR ACCURATE. THE CONTRACTOR MUST COORDINATE DIRECTLY WITH THE INVOLVED UTILITY OWNERS TO HAVE THE UNDERGROUND UTILITY LINES FIELD VERIFIED PRIOR TO CONSTRUCTION. IF PROPOSED UTILITIES ARE FOUND IN CONFLICT WITH EXISTING UTILITIES, THE ENGINEER SHALL BE NOTIFIED AND THE PROPOSED UTILITIES SHALL BE INSTALLED IN A DESIGNATED LOCATION TO AVOID CONFLICT.
 - 14 TWO 45° FITTINGS SHALL BE INSTALLED WHERE STORM PIPES CONNECT AT 90°. CLEANOUTS, WHERE SHOWN, SHALL BE INSTALLED AT THE DOWNSTREAM 45° FITTING.
 - 15 CONTRACTOR SHALL REFERENCE BURNS COOLEY DENNIS, INC. GEOTECHNICAL INVESTIGATION "ADDITIONS TO GRACE CROSSING CHURCH" DATED JULY 10, 2020, FOR ALL SUBGRADE PREPARATION AND PAVEMENT CONSTRUCTION. THE CONTRACTOR SHALL NOTIFY THE OWNER AND ENGINEER OF ANY DISCREPANCY BETWEEN THE GEOTECHNICAL REPORT AND CONSTRUCTION DOCUMENTS PRIOR TO COMMENCING CONSTRUCTION ACTIVITIES.

GRADING PLAN LEGEND:

206	EXISTING MINOR CONTOUR
200	EXISTING MAJOR CONTOUR
327	MINOR CONTOUR, NEW
330	MAJOR CONTOUR, NEW
	NEW CATCH BASIN/ AREA INLET
	STORM DRAIN PIPE, NEW (ST S)
EXSD	EXISTING STORM DRAIN
EXOHE	EXISTING OVERHEAD ELECTRIC
EXUC	EXISTING UNDERGROUND COMMUNICATIONS LINE
EXUE	EXISTING UNDERGROUND ELECTRIC
EXSS	EXISTING SANITARY SEWER LINE
EXW	EXISTING WATER LINE
	SANITARY SEWER MANHOLE
	SPOT ELEVATION
	TOP OF CURB ELEVATION
	TOP OF PAVEMENT ELEVATION
	EXISTING ELEVATION



GRADING PLAN
SCALE: 1"=20'-0"

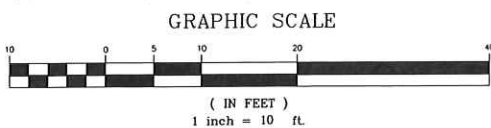

cafl.com
601.366.3110
3221 Old Canton Rd
Suite 200
Jackson, MS
39216

PROJECT NUMBER	19072
DATE	11/13/2020
DRAWN BY	RMC

NO.	DATE	REVISIONS

Grace Crossing Baptist Church Expansion
598 Yandell Rd, Canton, MS 39046
Owner

NOT FOR CONSTRUCTION Permit Set

GRADING PLAN
C131

- UTILITY NOTES:**
- 1 EXISTING UNDERGROUND UTILITY LINES ARE SHOWN ON THE PLANS BASED UPON THE BEST INFORMATION AVAILABLE TO THE ENGINEER. THE ENGINEER CANNOT AND DOES NOT WARRANT THAT THIS INFORMATION IS COMPLETE OR ACCURATE. THE CONTRACTOR MUST COORDINATE DIRECTLY WITH THE INVOLVED UTILITY OWNERS TO HAVE THE UNDERGROUND UTILITY LINES FIELD VERIFIED PRIOR TO CONSTRUCTION. IF PROPOSED UTILITIES ARE FOUND IN CONFLICT WITH EXISTING UTILITIES, THE ENGINEER SHALL BE NOTIFIED AND THE PROPOSED UTILITIES SHALL BE INSTALLED IN A DESIGNATED LOCATION TO AVOID CONFLICT. CONTRACTOR SHALL USE EXTREME CAUTION WHEN WORKING NEAR ACTIVE UTILITIES.
 - 2 CONTRACTOR SHALL BE RESPONSIBLE FOR ALL NECESSARY INSPECTIONS, APPROVALS AND/OR CERTIFICATIONS REQUIRED BY CODES AND AUTHORITIES.
 - 3 CONTRACTOR SHALL MAINTAIN A 10' HORIZONTAL AND 18" VERTICAL SEPARATION BETWEEN WATER, STORM AND SANITARY SEWER.
 - 4 CONTRACTOR SHALL NOT OPEN, TURN OFF, INTERFERE WITH OR ATTACH ANY PIPE OR HOSE TO OR TAP ANY WATER MAIN OR OTHER UTILITIES BELONGING TO THE UTILITY AUTHORITY UNLESS DULY AUTHORIZED TO DO SO BY THE UTILITY AUTHORITY. ANY ADVERSE OR UNSCHEDULED DISRUPTIONS OF SERVICE TO THE PUBLIC ARE TO BE THE LIABILITY OF THE CONTRACTOR.
 - 5 CONTRACTOR SHALL REPAIR PAVEMENT PER PAVEMENT DETAIL TO MATCH EXISTING WIDTH WHERE UTILITY CROSSING IS REQ'D. CONTRACTOR SHALL ENSURE A SMOOTH CONNECTION BETWEEN THE NEW AND EXISTING PAVEMENT.
 - 6 ALL NEW UTILITIES INSTALLED AS A PART OF THIS PROJECT SHALL BE INSTALLED WITH TRACER WIRE.
 - 7 ALL NEW DUCTILE IRON FITTINGS (TEES, ELBOWS, VALVES, ETC.) TO BE INSTALLED USING MEGA-LUG RESTRAINT GLANDS.
 - 8 CONTRACTOR SHALL VERIFY DEPTH OF EXISTING UTILITIES PRIOR TO COMMENCING CONSTRUCTION ACTIVITIES. CONTRACTOR SHALL NOTIFY THE ENGINEER AND OWNER OF ANY CONFLICTS WITH THE DEPTH OF THE EXISTING UTILITIES AND PROPOSED UTILITIES PRIOR TO COMMENCING CONSTRUCTION ACTIVITIES.
 - 9 ALL DOMESTIC WATER SERVICE LINES SHALL BE HDPE PRESSURE CLASS 200 WATER LINE. ALL FIRE WATER LINES SHALL BE DR 18 C900 PVC UNLESS NOTED OTHERWISE.
 - 10 PRIOR TO THE COMPLETION OF THE PROJECT, THE CONTRACTOR SHALL TEST THE SANITARY SEWER SYSTEM PER THE TECHNICAL SPECIFICATIONS AND ANY ADDITIONAL TESTING REQ'D BY THE AUTHORITY HAVING JURISDICTION. THE CONTRACTOR IS RESPONSIBLE FOR COORDINATING ALL TESTING REQUIREMENTS WITH THE CITY AND ENSURING ALL NEW SANITARY SEWER ITEMS MEET THOSE REQUIREMENTS.
 - 11 CONTRACTOR SHALL REFERENCE THE ELECTRICAL PLANS, THIS SET, FOR ALL INFORMATION REGARDING THE ELECTRICAL SITE LAYOUT.
 - 12 STEEL CASING PIPE SHALL BE ASTM A 252, GRADE 2 WITH SCHEDULE 40 MINIMUM WALL THICKNESS. CASING SPACERS SHALL BE MODEL S818 DESIGNED AND MANUFACTURED BY ADVANCE PRODUCTS & SYSTEMS OR APPROVED EQUAL.
 - 13 ALL TRENCHES TO BE BACKFILLED AND COMPACTED TO 96% STANDARD PROCTOR DENSITY (ASTM D698). REFER TO THE TECHNICAL SPECIFICATIONS FOR ADDITIONAL COMPACTION REQUIREMENTS.
 - 14 CONTRACTOR SHALL MAINTAIN A 3' CLEARANCE AROUND ALL FIRE HYDRANTS. NOTIFY THE ARCHITECT PRIOR TO COMMENCING CONSTRUCTION IF CLEARANCE CAN NOT BE MAINTAINED.
 - 15 THE CONTRACTOR SHALL INCLUDE IN HIS BASE BID ALL WORK REQUIRED TO PROVIDE WATER SERVICE TO THE PROPOSED NEW BUILDING AS SHOWN ON THE BID DOCUMENTS. THE CONTRACTOR SHALL COORDINATE ALL REQUIREMENTS WITH THE WATER UTILITY PROVIDER PRIOR TO COMMENCING CONSTRUCTION.

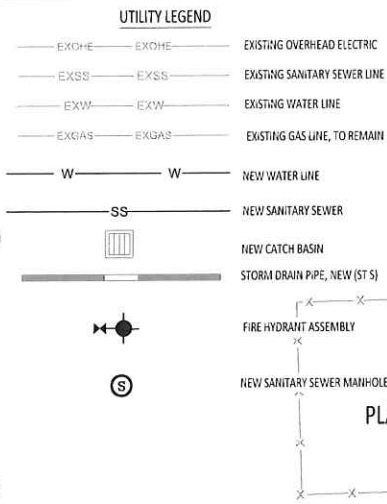

EXISTING GRACE CROSSING CHURCH BUILDING
FFE=279.60

GRACE CROSSING BUILDING ADDITION
FFE=279.60

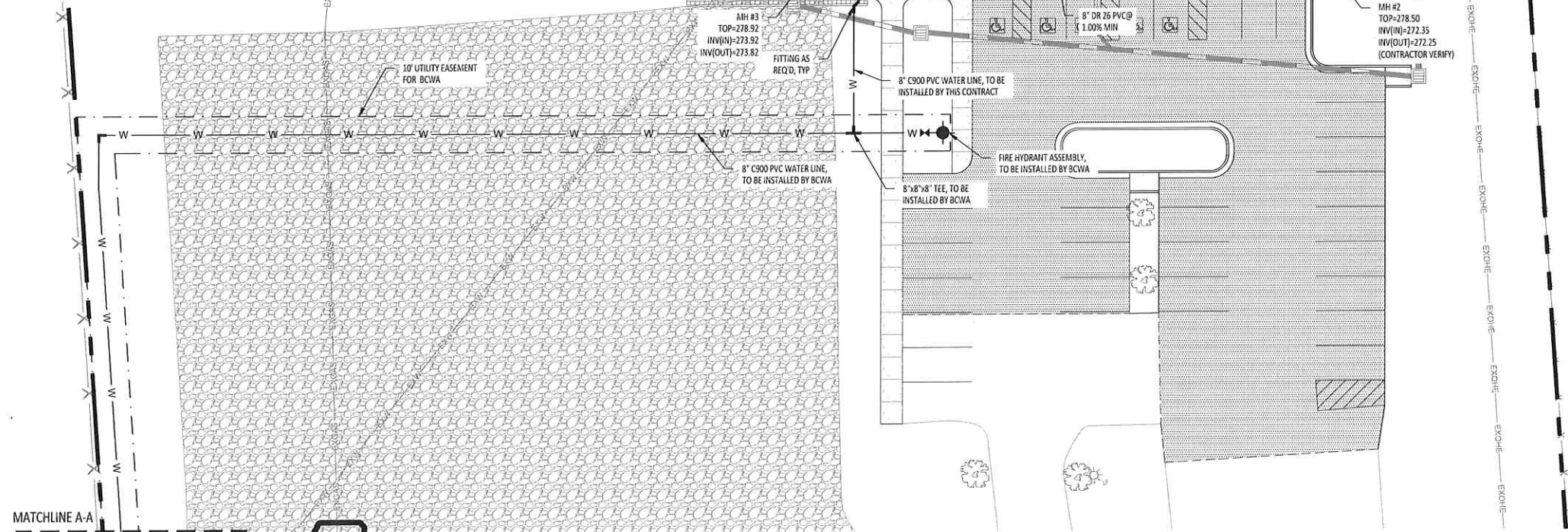

UTILITY PLAN
SCALE: 1"=20'-0"

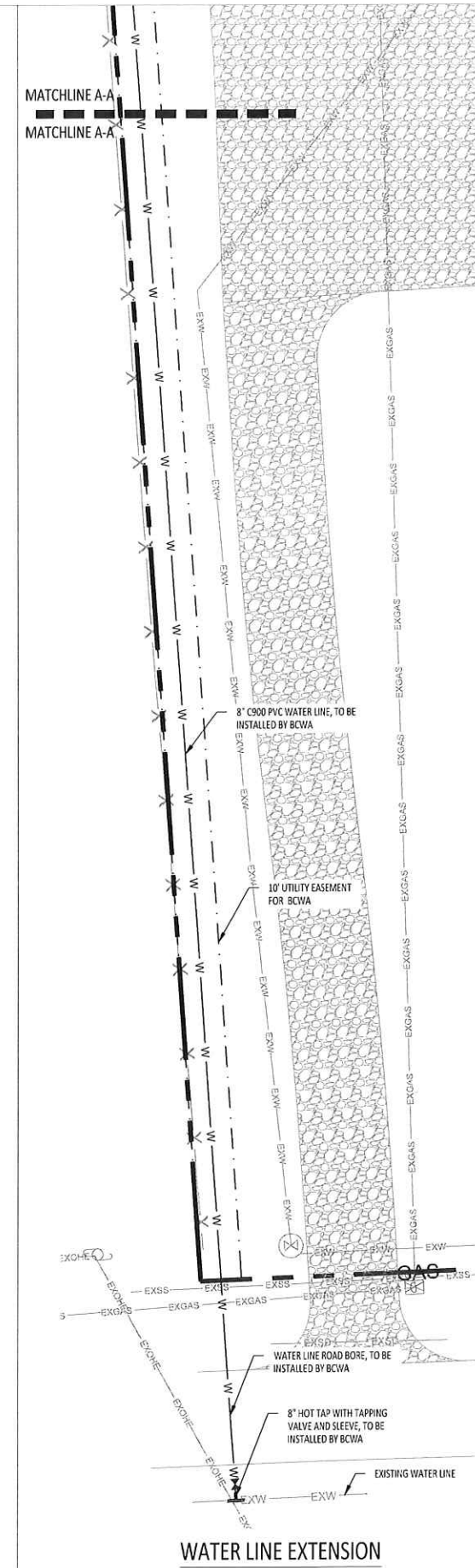
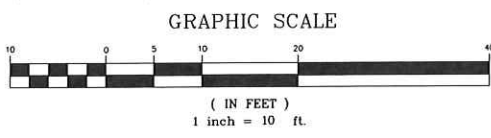

WATER LINE EXTENSION



cdell.com
601.366.3110
3221 Old Canton Rd
Suite 200
Jackson, MS
39216

PROJECT NUMBER 19072
DATE 11/13/2020
DRAWN BY RMC

REVISIONS NO.	DATE

Grace Crossing Baptist Church
Expansion
598 Yandell Rd, Canton, MS
39046
Owner

NOT FOR CONSTRUCTION
Permit Set

UTILITY PLAN

C141

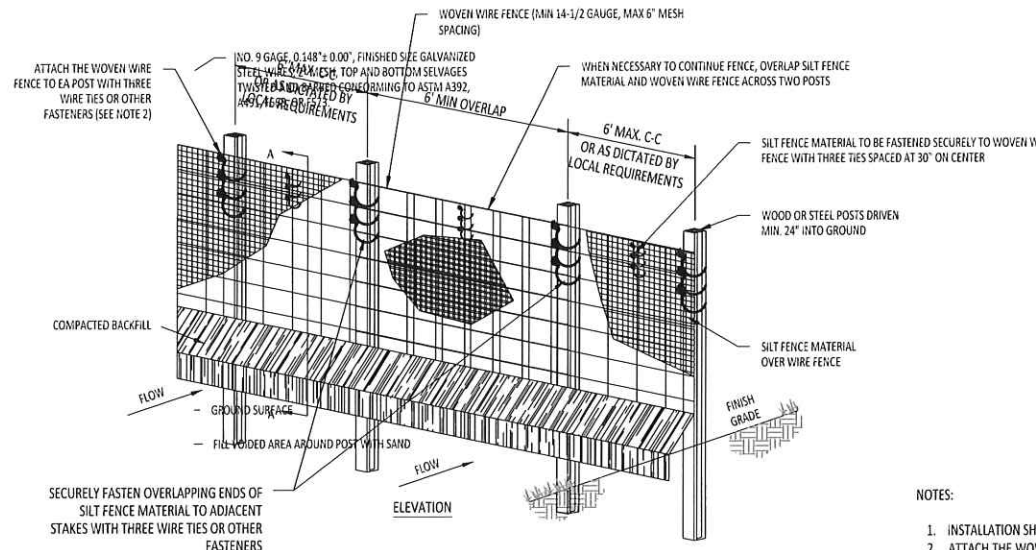

1 SEDIMENTATION/SILT FENCE WITH WIRE SUPPORT
SCALE: NOT TO SCALE

NOTES:

1. INSTALLATION SHALL COMPLY WITH ASTM D 6462 LATEST EDITION.
2. ATTACH THE WOVEN WIRE FENCE TO EACH POST AND THE GEOTEXTILE TO THE WOVEN WIRE FENCE (SPACED EVERY 30") WITH THREE WIRE TIES OR OTHER FASTENERS, ALL SPACED WITHIN THE TOP 8" OF THE FABRIC. ATTACH EACH TIE DIAGONALLY 45 DEGREES THROUGH THE FABRIC, WITH EACH PUNCTURE AT LEAST 1" VERTICALLY APART. ALSO, EACH TIE PLACED ON A POST SHOULD BE POSITIONED TO HANG ON A POST NIPPLE WHEN TIGHTENED TO PREVENT SAGGING.
3. WHEN TWO SECTIONS OF SILT FENCE MATERIAL ADJOIN EACH OTHER, THEY SHALL BE OVERLAPPED A MINIMUM OF 72" ACROSS TWO POSTS, AS SHOWN.
4. MAINTENANCE SHALL BE PERFORMED AS NOTED IN THE SPECIFICATIONS. DEPTH OF ACCUMULATED SEDIMENTS MAY NOT EXCEED ONE-THIRD THE HEIGHT OF THE FENCE. MAINTENANCE CLEANOUT MUST BE CONDUCTED REGULARLY TO PREVENT ACCUMULATED SEDIMENTS FROM REACHING ONE-HALF THE HEIGHT OF THE SILT FENCE MATERIAL ABOVE GRADE.
5. ALL SILT FENCE SHALL INCLUDE WIRE SUPPORT.
6. WRAP APPROXIMATELY 6" OF FABRIC AROUND THE END POSTS AND SECURE WITH 3 TIES.
7. COMPACT THE SOIL IMMEDIATELY NEXT TO THE SILT FENCE FABRIC WITH THE FRONT WHEEL OF THE TRACTOR, SKID STEER, OR ROLLER EXERTING AT LEAST 60 POUNDS PER SQ. INCH. COMPACT THE UPSTREAM SIDE FIRST. COMPACT EACH SIDE TWICE FOR A TOTAL OF FOUR TRIPS.
8. ADD POST CAPS AS NEEDED BASED ON SITE CONDITIONS AND APPLICABLE AGENCY REQUIREMENTS.

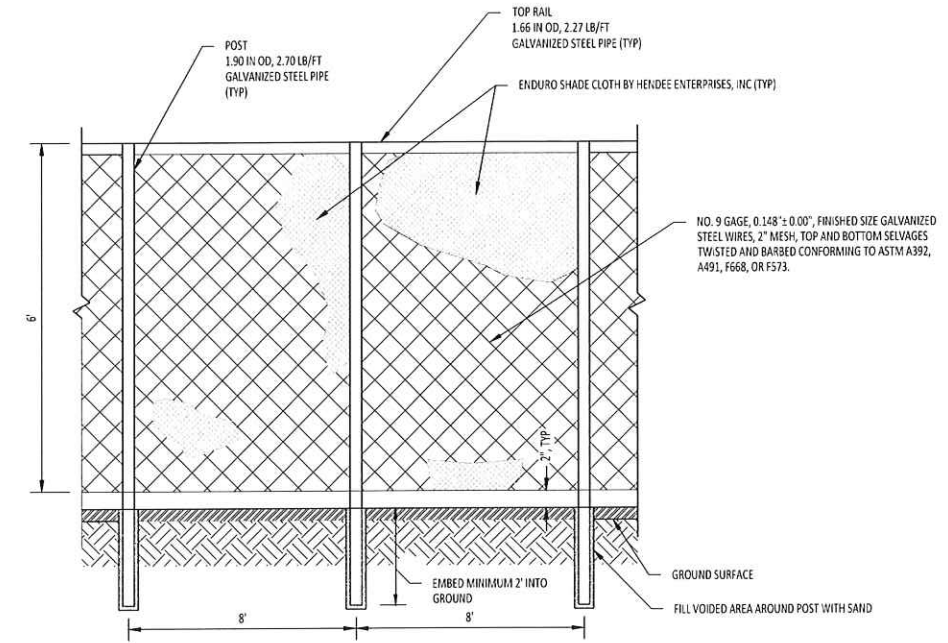
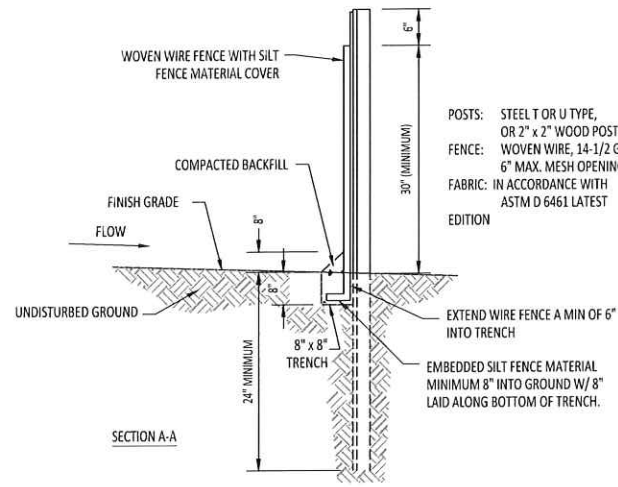

2 TEMPORARY CONSTRUCTION FENCE
SCALE: NOT TO SCALE

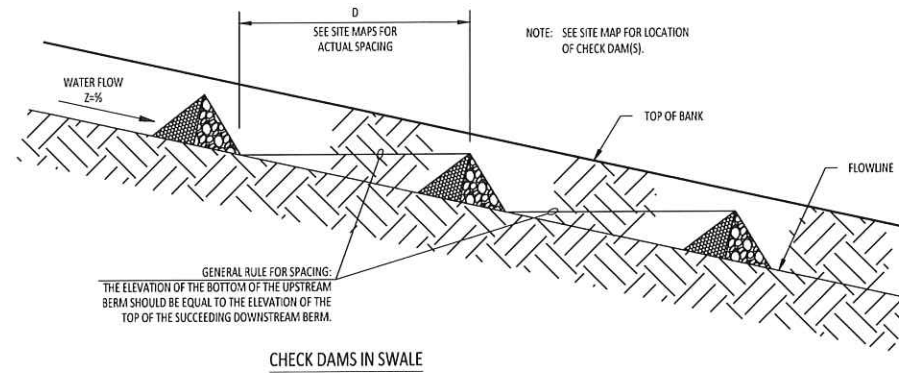

CHECK DAMS IN SWALE

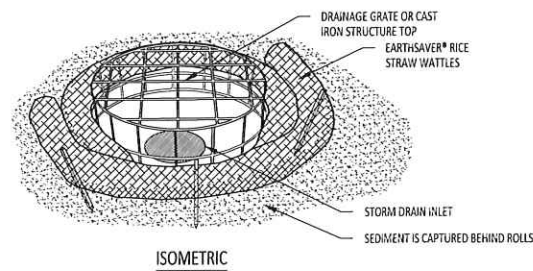

NOTES:

1. INSTALLATION TO BE COMPLETED WITH MANUFACTURER'S SPECIFICATIONS.
2. DO NOT SCALE DRAWINGS.
3. FIBER ROLLS SHOULD BE INSPECTED AFTER EVERY SIGNIFICANT STORM EVENT TO CLEAR AND DISPOSE OF SEDIMENT AND DEBRIS.

3 STRAW WATTLES AT STRUCTURE
SCALE: NOT TO SCALE

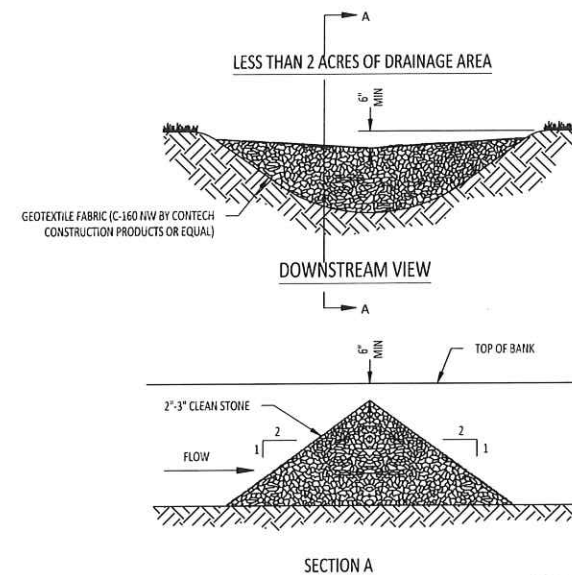

SECTION A

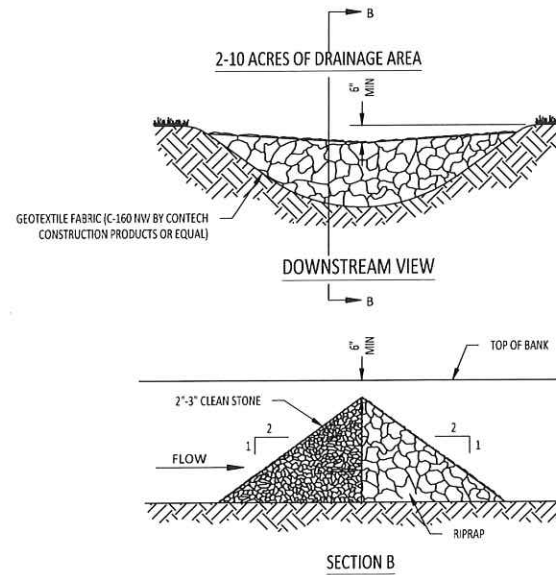

SECTION B

4 ROCK CHECK DAM
SCALE: NOT TO SCALE

REVISIONS	NO.	DATE

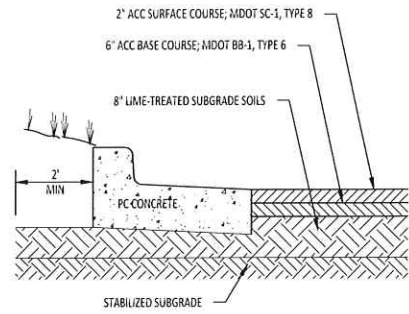

ASPHALT PAVING

- FOR PREPARATION OF PAVEMENT SUBGRADE, FILL PLACED IN 9 INCH LIFTS TO WITHIN 9 INCHES OF FINISHED SUBGRADE ELEVATION IN FILL AREAS AND AT LEAST THE UPPER 9 INCHES OF SUBGRADE IN ALL AREAS TO BE PAVED SHALL BE COMPACTED TO AT LEAST 95% OF THE MATERIAL'S MAXIMUM STANDARD PROCTOR DRY DENSITY (ASTM D-698). FILL PLACED BELOW THIS LEVEL SHALL BE COMPACTED TO AT LEAST 95% OF THE MATERIAL'S MAXIMUM DRY DENSITY. THE SOIL'S WATER CONTENT SHALL BE AT -3% TO +3% OF THE SOIL'S OPTIMUM MOISTURE VALUE AT TIME OF COMPACTION. WHERE HAND OPERATED MECHANICAL TAMPERS ARE USED, THE LOOSE LIFT THICKNESS SHALL NOT EXCEED 5".
- AFTER PROOFROLLING WITH A LOADED TANDEM AXLE DUMP TRUCK AND REPAIRING DEEP SUBGRADE DEFICIENCIES, THE ENTIRE SUBGRADE SHALL BE SCARIFIED TO A DEPTH OF 6 INCHES AND UNIFORMLY COMPACTED TO AT LEAST 95% OF STANDARD PROCTOR MOISTURE CONTENT AT THE TIME OF COMPACTION.
- AGGREGATE GRAVEL BASE COURSE MIXTURES SHALL BE MDOT SIZE NO. 610 CRUSHED LIMESTONE, COMPACTED TO 100% OF THE MAXIMUM DRY DENSITY IN ACCORDANCE WITH ASTM D-698 (STANDARD PROCTOR) AT -2% TO +2% OF THE SOIL'S OPTIMUM MOISTURE CONTENT AT THE TIME OF COMPACTION.
- ASPHALT CONCRETE SURFACE COURSE SHALL BE MDOT SC-1, TYPE 8 AND ASPHALT CONCRETE BASE COURSE SHALL BE MDOT BB-1, TYPE 6 IN ACCORDANCE WITH THE 1990 EDITION OF THE MISSISSIPPI STANDARD SPECIFICATION FOR ROAD AND BRIDGE CONSTRUCTION.
- THE PORTLAND CEMENT CONCRETE PAVEMENT MIXTURE SHALL BE IN ACCORDANCE WITH AIR-ENTRAINED CONCRETE FOR PAVEMENT AS PER ASTM C-31. PORTLAND CEMENT CONCRETE SHALL BE CONSTRUCTED IN ACCORDANCE WITH THE LATEST ACI, ASTM, AND PCA STANDARDS, INCLUDING THICKENED EXTERIOR EDGES AND CORNERS, AND LOAD TRANSFER DEVICES. THE MIXTURE SHALL BE DESIGNED TO DEVELOP A MINIMUM COMPRESSIVE STRENGTH OF 4000 PSI AT 28 DAYS.
- CONTRACTOR SHALL PROVIDE A PRIME COAT AND TACK COAT. SEE PROJECT SPECIFICATIONS FOR ADDITIONAL INFORMATION.
- THE FIRST 8" OF STABILIZED SUBGRADE MATERIAL UNDER PAVEMENT SHALL BE LIME TREATED USING 6% HYDRATED LIME BY DRY WEIGHT OF SOIL. LIME TREATMENT SHALL BE PERFORMED IN ACCORDANCE WITH SECTION 307 OF THE 1990 EDITION OF THE MISSISSIPPI STANDARD SPECIFICATIONS FOR ROAD AND BRIDGE CONSTRUCTION USING THE CLASS C LIME TREATMENT PROCEDURE. LIME TREATMENT SHALL EXTEND NOT LESS THAN 2" BEYOND PAVEMENT EDGES.
- FOR CRUSHED STONE PAVEMENTS THE CONTRACTOR MAY ELECT TO REUSE EXISTING CRUSHED STONE FROM THE EXISTING GRAVEL PARKING AREA. THE STONE TO BE REUSED SHALL HAVE A MAX 12% PASSING THE NO. 200 SIEVE. THE TESTING LAB SHALL TEST THE MATERIAL TO DETERMINE IF IT IS SUITABLE PRIOR TO PLACEMENT. IT IS THE CONTRACTOR'S RESPONSIBILITY TO ESTIMATE THE DEPTH OF EXISTING CRUSHED STONE THAT CAN BE REUSED. ANY ADDITIONAL STONE TO BE PLACED SHALL MEET THE MDOT REQUIREMENTS FOR NO. 610 CRUSHED LIMESTONE. THE CONTRACTOR SHALL INCLUDE THE PRICE FOR ANY ADDITIONAL CRUSHED STONE NECESSARY IN BASE BID. THE CONTRACTOR SHALL PLACE ANY EXISTING CRUSHED STONE TO BE REUSED IN THE INITIAL LIFT AND USE NEW IMPORTED STONE FOR THE SURFACE LIFT IN ALL AREAS SHOWN TO RECEIVE CRUSHED STONE.
- SOURCE: GEOTECHNICAL ENGINEERING REPORT PREPARED BY BURNS COOLEY DENNIS, INC. AND DATED JULY 10, 2020. PAVEMENT PREPARATION AND CONSTRUCTION SHALL BE IN CONFORMANCE WITH ALL GEOTECHNICAL RECOMMENDATIONS. THE ENGINEER SHALL BE NOTIFIED OF ANY DISCREPANCY BETWEEN THE PLANS AND GEOTECHNICAL REPORT PRIOR TO COMMENCING CONSTRUCTION ACTIVITIES.

1 PAVEMENT SECTIONS
SCALE: NOT TO SCALE

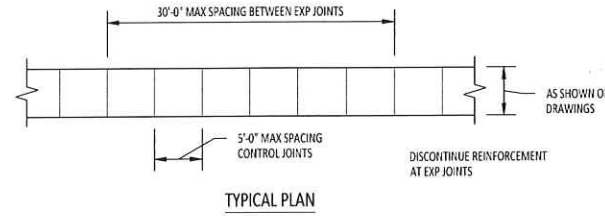

TYPICAL PLAN

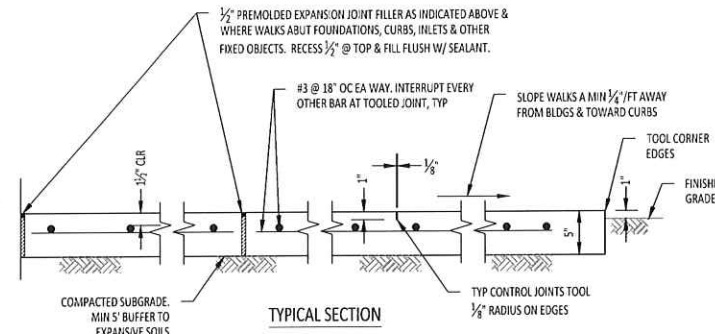

TYPICAL SECTION

2 CONCRETE SIDEWALK
SCALE: NOT TO SCALE

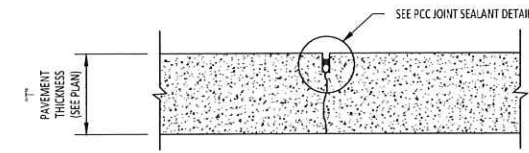

NOTE: SEE PLAN FOR JOINT SPACING. IF JOINTS ARE NOT SHOWN ON THE PLANS, REFER TO THE SPECIFICATIONS FOR JOINT SPACING

CONTRACTION JOINT

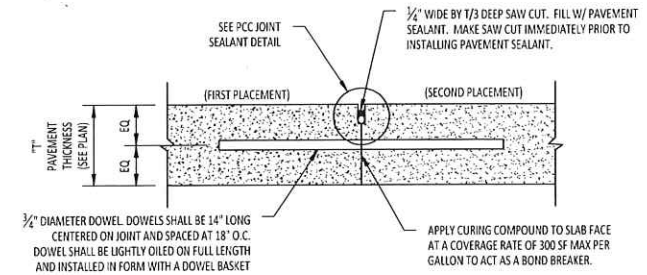

CONSTRUCTION JOINT

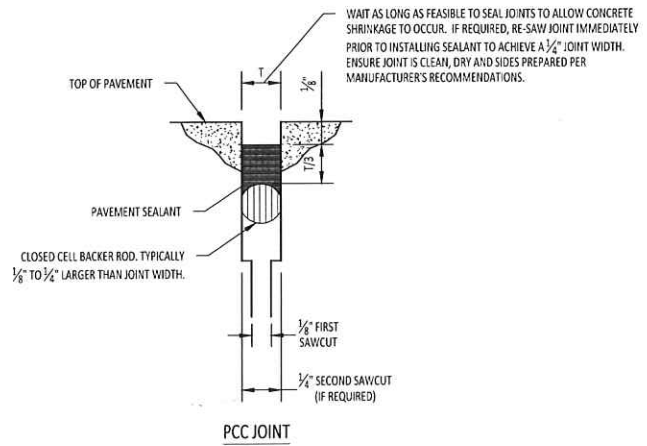

PCC JOINT

- NOTES:
- ENSURE JOINTS ARE CLEAN AND DRY PRIOR TO THE APPLICATION OF THE JOINT SEALANT.
 - INSTALL CLOSED CELL BACKER ROD AFTER JOINTS HAVE BEEN CLEANED AND DRIED IN ACCORDANCE WITH SEALANT MANUFACTURER'S REQUIREMENTS.
 - INSTALL BACKER ROD AT CONSISTENT AND UNIFORM DEPTH.
 - JOINT SEALANT APPLICATION SHALL BE IN STRICT COMPLIANCE WITH SEALANT MANUFACTURER'S REQUIREMENTS.
 - COMPACT SUBGRADE TO 95% STANDARD PROCTOR DENSITY (ASTM 698) PRIOR TO PLACING CONCRETE PAVEMENT.
 - CONCRETE STRENGTH SHALL BE 4000 PSI MIN.

3 CONCRETE JOINT
SCALE: NOT TO SCALE

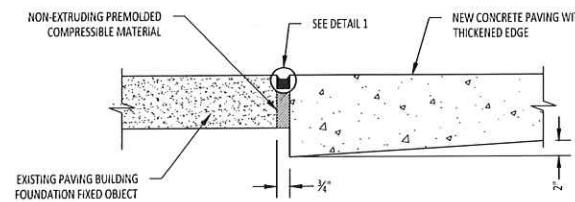

ISOLATION JOINT (I)

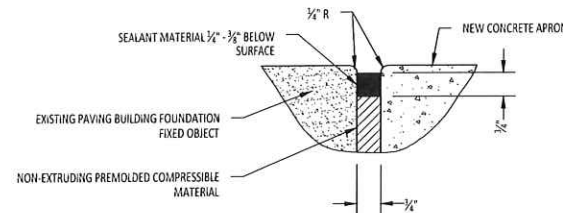

DETAIL 1 ISOLATION JOINT

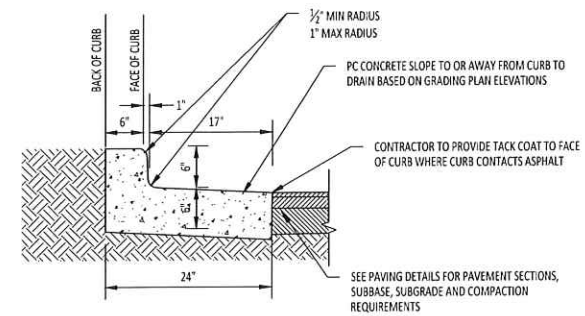

CURB AND GUTTER AT ASPHALT PAVEMENT

NOTE: GUTTER SLOPE TO MATCH ADJACENT PAVEMENT, TRANSVERSE AND LONGITUDINAL.

7 CURB AND GUTTER
SCALE: NOT TO SCALE

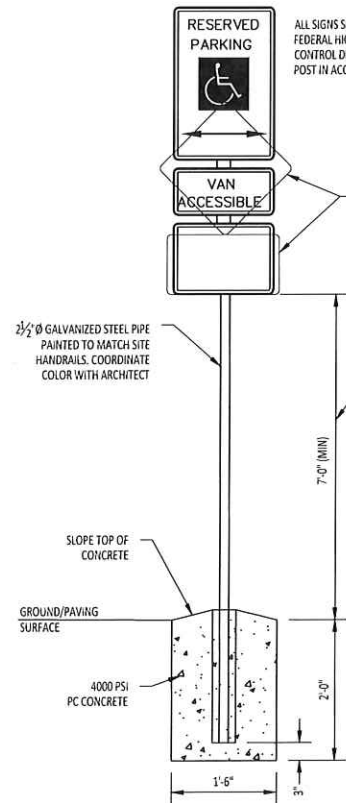

4 ADA SIGN DETAIL
SCALE: NOT TO SCALE

ALL SIGNS SHALL COMPLY WITH U.S. DEPARTMENT OF TRANSPORTATION, FEDERAL HIGHWAY ADMINISTRATION'S "MANUAL OF UNIFORM TRAFFIC CONTROL DEVICES", LOCAL CODES AND AS SPECIFIED. MOUNT SIGNS TO POST IN ACCORDANCE WITH MANUFACTURER'S INSTRUCTIONS.

R7-8
12' x 18'
THIS SIGN TYPICAL AT ALL ACCESSIBLE PARKING SPACES. (RELOCATE EXISTING SIGNAGE WHERE APPLICABLE)

R7-8p
12' x 6'
THIS SIGN TYPICAL AT ALL VAN ACCESSIBLE PARKING SPACES. (RELOCATE EXISTING SIGNAGE WHERE APPLICABLE)

SIGNAGE OTHER THAN ACCESSIBLE (PED XING, STOP, ETC.)

NOTE: THE MINIMUM HEIGHT OF THE BOTTOM OF THE LOWEST SIGN SHALL BE 7'-0"

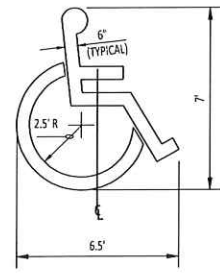

ACCESSIBLE PARKING SYMBOL
LOCATE AT EDGE OF PARKING SPACE UNLESS ACCOMPANIED BY "VAN" LETTERING

5 ADA PARKING SYMBOL
SCALE: 1/2"=1'-0"

6 CONCRETE ISOLATION JOINT
SCALE: NOT TO SCALE

call.com
601.366.3110
3221 Old Canton Rd
Sulite 200
Jackson, MS
39216

PROJECT NUMBER	19072	DATE	11/13/2020	DRAWN BY	RMC
REVISIONS	DATE				
NO.					

Grace Crossing Baptist Church
Expansion
588 Yandell Rd, Canton, MS
39046
Owner

NOT FOR CONSTRUCTION
Permit Set

CIVIL DETAILS

C202



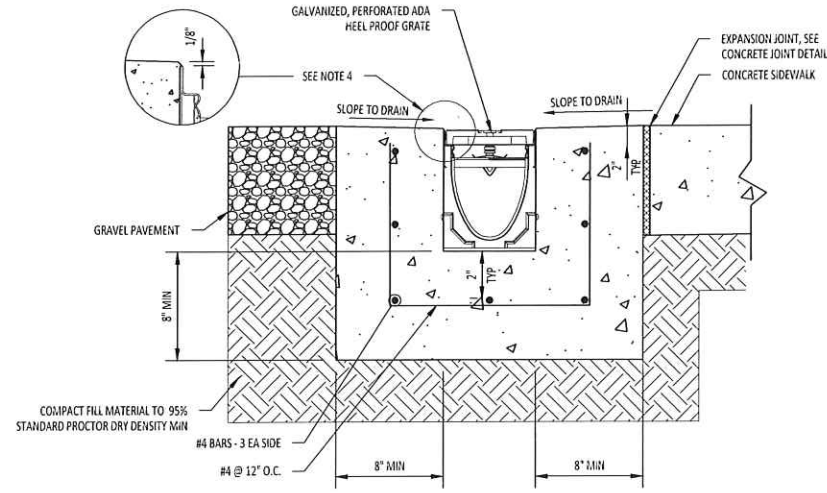

- NOTES:
- IT IS NECESSARY TO ENSURE MINIMUM DIMENSIONS SHOWN ARE SUITABLE FOR EXISTING GROUND CONDITIONS.
 - MINIMUM CONCRETE STRENGTH OF 4,000 PSI IS REQUIRED. CONCRETE SHOULD BE VIBRATED TO ELIMINATE AIR POCKETS.
 - EXPANSION AND CONTRACTION CONTROL JOINTS AND REINFORCEMENT ARE REQUIRED TO PROTECT CHANNEL AND CONCRETE.
 - THE FINISHED LEVEL OF THE CONCRETE SURROUND MUST BE APPROX. 1/8" [3mm] ABOVE THE TOP OF THE CHANNEL EDGE.
 - CONCRETE BASE THICKNESS SHOULD MATCH SLAB THICKNESS. ENGINEERING ADVICE MAY BE REQUIRED TO DETERMINE PROPER LOAD CLASS.
 - REFER TO ACO'S LATEST INSTALLATION INSTRUCTIONS FOR FURTHER DETAILS.
 - ENCASEMENT AND MATERIAL REQUIREMENTS ARE TAKEN FROM THE MANUFACTURER'S DETAIL FOR AN ACO DRAIN K300 TRENCH DRAIN. THE CONTRACTOR SHALL SUBMIT A SIMILAR OR EQUAL TRENCH DRAIN PRODUCT MEETING THE REQUIREMENTS OF THE CONTRACT DOCUMENTS. GRATE TO BE USED SHALL BE ACO TYPE 611D ADA GALVANIZED STEEL GRATE OR EQUAL.

1 TRENCH DRAIN DETAIL
C203 SCALE: NOT TO SCALE

SPECIFICATION CLAUSE

K300 KLASSIKDRAIN - LOAD CLASS C

GENERAL
THE SURFACE DRAINAGE SYSTEM SHALL BE POLYMER CONCRETE K200 CHANNEL SYSTEM WITH GALVANIZED STEEL EDGE RAILS AS MANUFACTURED BY ACO POLYMER PRODUCTS, INC.

MATERIALS
CHANNELS SHALL BE MANUFACTURED FROM POLYESTER RESIN POLYMER CONCRETE WITH AN INTEGRALLY CAST-IN GALVANIZED STEEL EDGE RAIL. MINIMUM PROPERTIES OF POLYMER CONCRETE WILL BE AS FOLLOWS:
 COMPRESSIVE STRENGTH: 14,000 PSI
 FLEXURAL STRENGTH: 4,000 PSI
 TENSILE STRENGTH: 1,500 PSI
 WATER ABSORPTION: 0.07%
 FROST PROOF: YES
 DILUTE ACID AND ALKALI RESISTANT: YES
 8117 SALT SPRAY TEST COMPLIANT: YES

THE SYSTEM SHALL BE 8" (200mm) NOMINAL INTERNAL WIDTH WITH A 10 2" (260mm) OVERALL WIDTH AND A BUILT-IN SLOPE OF 0.5%. CHANNEL INVERT SHALL HAVE DEVELOPED "V" SHAPE. ALL CHANNELS SHALL BE INTERLOCKING WITH A MALE/FEMALE JOINT.

THE COMPLETE DRAINAGE SYSTEM SHALL BE BY ACO POLYMER PRODUCTS, INC. ANY DEVIATION OR PARTIAL SYSTEM DESIGN AND/OR IMPROPER INSTALLATION WILL VOID ANY AND ALL WARRANTIES PROVIDED BY ACO POLYMER PRODUCTS, INC.

CHANNEL SHALL WITHSTAND LOADING TO PROPER LOAD CLASS AS OUTLINED BY EN 1433. GRATE TYPE SHALL BE APPROPRIATE TO MEET THE SYSTEM LOAD CLASS SPECIFIED AND INTENDED APPLICATION. GRATES SHALL BE SECURED USING 'QUICKLOK' BOLTLESS LOCKING SYSTEM. CHANNEL AND GRATE SHALL BE CERTIFIED TO MEET THE SPECIFIED EN 1433 LOAD CLASS. THE SYSTEM SHALL BE INSTALLED IN ACCORDANCE WITH THE MANUFACTURER'S INSTRUCTIONS AND RECOMMENDATIONS.

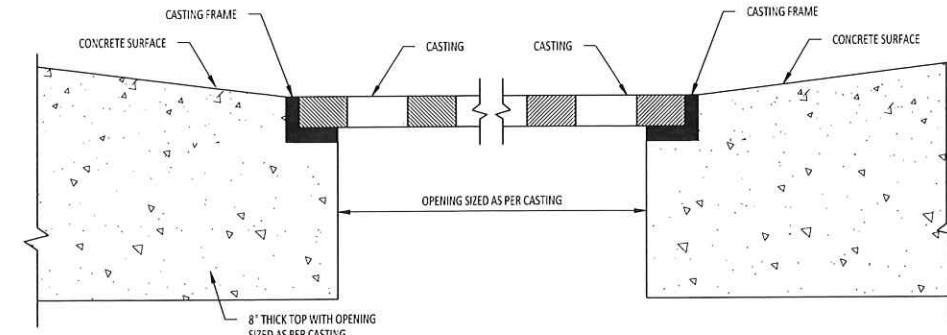

CASTING CONNECTION

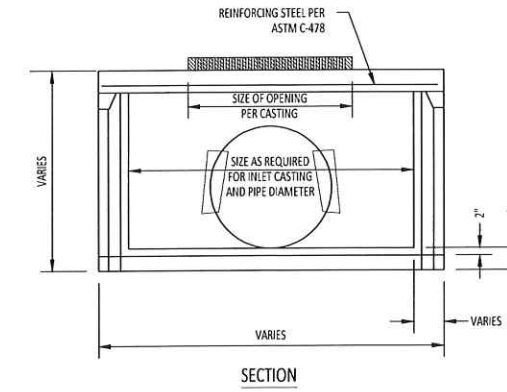

SECTION

- NOTES:
- ALL STRUCTURES SHALL BE DESIGNED PER ASTM C-478 FOR HEAVY DUTY (H20) LOADINGS.
 - INVERT SHALL BE BUILT IN THE FIELD BY THE CONTRACTOR TO PROVIDE SMOOTH FLOW THROUGH THE CATCH BASIN.
 - ALL PRECAST CATCH BASINS SHALL BE MDOT TYPE SS-3 OR APPROVED EQUIVALENT.
 - GRATES SHALL BE EAST JORDAN IRON WORKS V-5726 OR APPROVED EQUAL. GRATES IN PEDESTRIAN AREAS SHALL BE V-4726-80 ADA GRATES.

2 PRECAST CATCH BASIN
C204 SCALE: 1"=1'-0"

cdfl.com
601.366.3110
3221 Old Canton Rd
Suite 200
Jackson, MS
39216

PROJECT NUMBER	19072	DATE	11/13/2020	DRAWN BY	RMC
REVISIONS	NO.	DATE			

Grace Crossing Baptist Church
Expansion
598 Yandell Rd, Canton, MS
39046
Owner

NOT FOR CONSTRUCTION
Permit Set

CIVIL DETAILS

C203

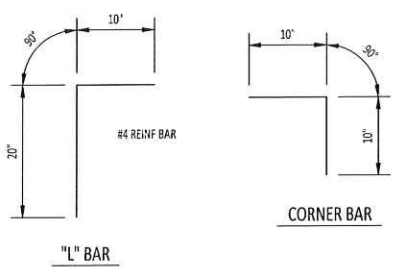
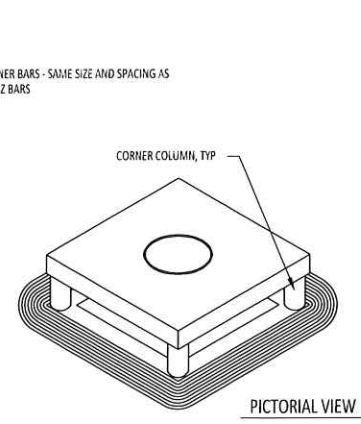
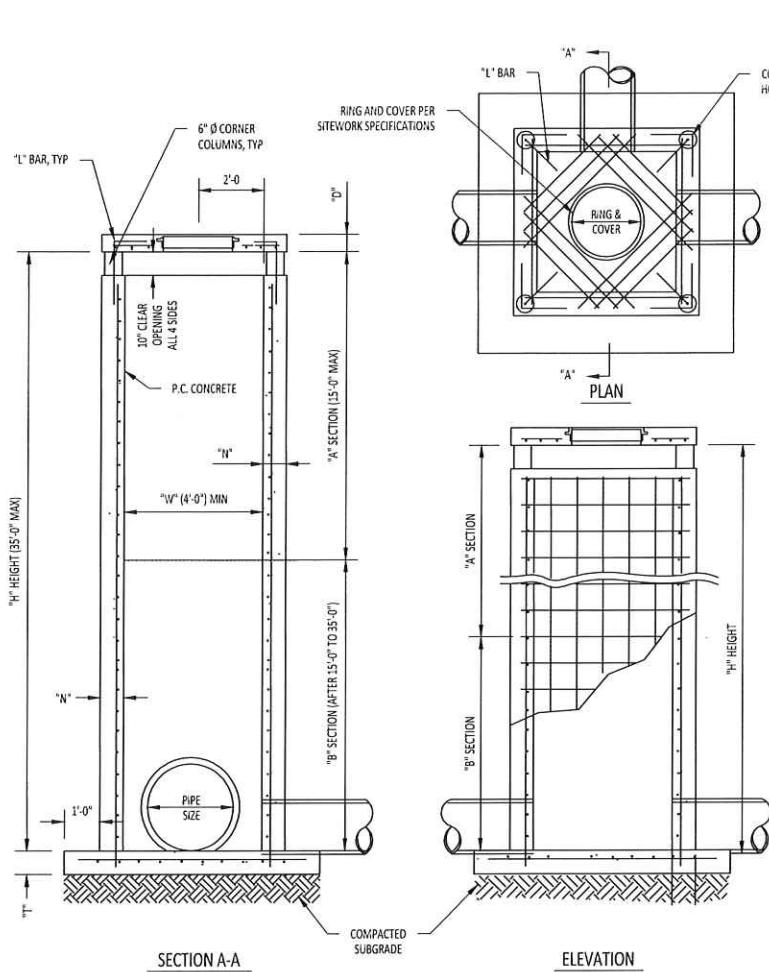

REINFORCEMENT SCHEDULE, BASE	
SECTION	
"A"	#4's @ 6" E.W.
"B"	#6's @ 6" E.W.

TABLE OF "W" DIMENSIONS				
PIPE SIZE	SKEW OF CROSS DRAIN			
	SINGLE	STRAIGHT	30°	45°
24"	4'-0"	4'-0"	4'-10"	4'-10"
30"	4'-0"	4'-0"	4'-7"	5'-8"
36"	4'-0"	5'-3"	6'-5"	6'-5"
42"	5'-3"	5'-11"	7'-3"	7'-3"
48"	5'-10"	6'-7"	8'-0"	8'-0"
60"	7'-0"	7'-10"	9'-8"	9'-8"
DOUBLE FOR "A" SECTION ONLY				
24"	7'-0"	7'-10"	9'-5"	9'-5"
30"	8'-2"	9'-2"	11'-0"	11'-0"
36"	9'-4"	10'-6"	12'-6"	12'-6"
42"	10'-6"	11'-10"	14'-2"	14'-2"
48"	11'-8"	13'-2"	15'-10"	15'-10"

- GENERAL NOTES:**
- ALL EXPOSED CORNERS TO HAVE 1/4" CHAMFER
 - ALL REINFORCING BARS TO HAVE 2" COVER
 - SEE GRADING AND DRAINAGE PLAN FOR PIPE SIZES, LOCATIONS, AND FLOW LINES
 - PIPES SHALL CONNECT TO THE ENDS OR SIDES OF THE INLET. CONNECTION SHALL NOT BE MADE AT CORNERS OF BOX.
 - ALL REINFORCING BARS TO BE GRADE 60.
 - PRECAST MANHOLE MAY BE USED UNLESS OTHERWISE NOTED OR DIRECTED BY THE ENGINEER.

PRECAST MANHOLE SPECIFICATIONS
 ASTM C478
 CONCRETE: 4000 PSI (MIN.)
 JOINT: WATERTIGHT RUBBER GASKET

REINFORCEMENT SCHEDULE, WALLS			
SECTION	WIDTH ("W")	HOR.	VERT.
"A"	4'	#4's @ 9"	#4's @ 10"
	BETWEEN 4' & 7'	#6's @ 9"	#4's @ 10"
	GREATER THAN 7'	#5's @ 4 1/2"	#4's @ 10"
"B"	4'	#4's @ 6"	#4's @ 10"
	BETWEEN 4' & 7'	#6's @ 6"	#4's @ 10"

TABLE OF "T" & "N" DIMENSIONS				
SECTION	WIDTH ("W")	"T"	"N"	"D"
"A"	BETWEEN 4' & 7'	6" + PIPE THICKNESS	8"	6"
	GREATER THAN 7'	6" + PIPE THICKNESS	8"	8"
"B"	4'	6" + PIPE THICKNESS	8"	8"
	BETWEEN 4' & 7'	6" + PIPE THICKNESS	10"	8"

REINFORCEMENT SCHEDULE, TOP		
DIMENSIONS	STEEL	SPECIAL PATTERN
W1 = 7' OR LESS	#4's @ 8" E.W.	DIAGONAL @ COVER
W2 = 7' OR LESS	#4's @ 8" E.W.	DIAGONAL @ COVER
W1 = 7' OR LESS	#4's @ 8" E.W.	DIAGONAL @ COVER
W2 = 7' OR GREATER	#4's @ 6" E.W.	DIAGONAL @ COVER
W1 = 7' OR GREATER	#4's @ 6" E.W.	DIAGONAL @ COVER
W2 = 7' OR GREATER	#4's @ 6" E.W.	DIAGONAL @ COVER

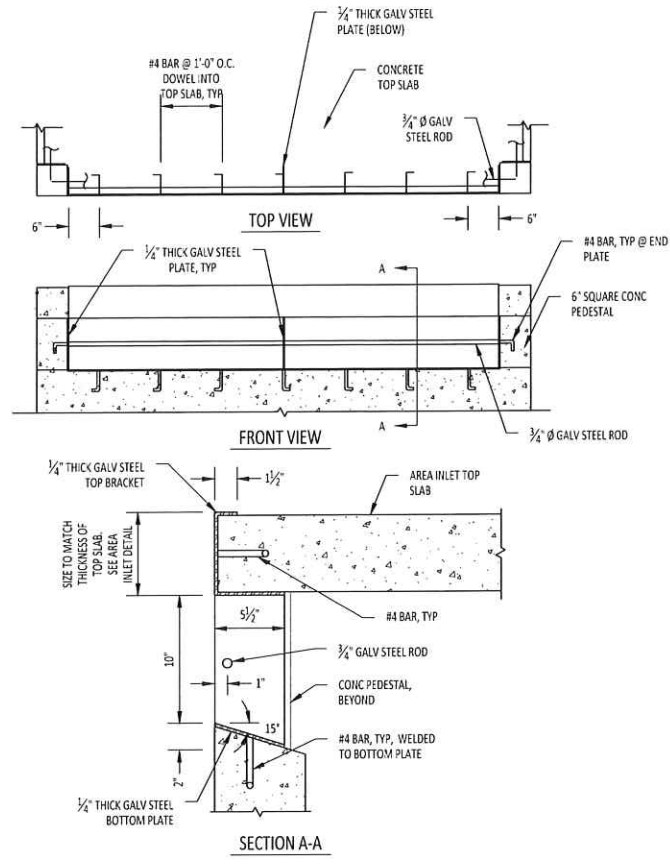

- STEEL INLET FRAME NOTES:**
- ALL JOINTS IN STEEL FRAME SHALL BE SHOP WELDED. ALL WELDS SHALL BE PERFORMED IN ACCORDANCE WITH APPROPRIATE AWS SPECIFICATIONS AND PROCEDURES.
 - THE ENTIRE FRAME SHALL BE HOT DIP GALVANIZED IN ACCORDANCE WITH ASTM A-123 PRIOR TO INSTALLATION.
 - FRAME IS TO BE INSTALLED IN ALL FOUR OPENINGS OF AREA INLET.
 - CONTRACTOR MUST SUBMIT SHOP DRAWINGS TO CEC FOR REVIEW PRIOR TO FABRICATION.

AREA INLET FRAME
 SCALE: NOT TO SCALE

2 DOWNSPOUT BOOT
 SCALE: NOT TO SCALE

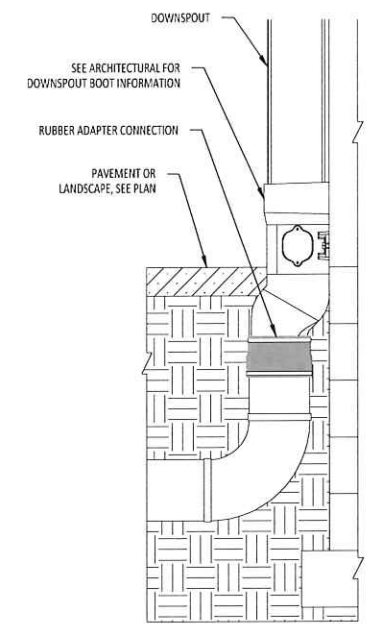

TYPICAL MOUNTING DETAIL

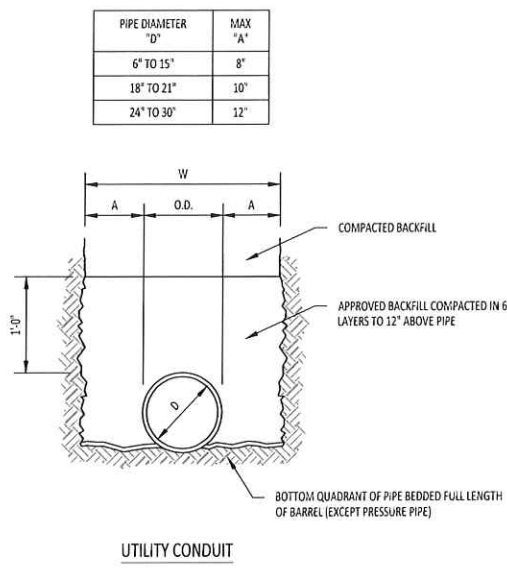

3 TYPICAL PIPE BEDDING DETAIL
 SCALE: NOT TO SCALE

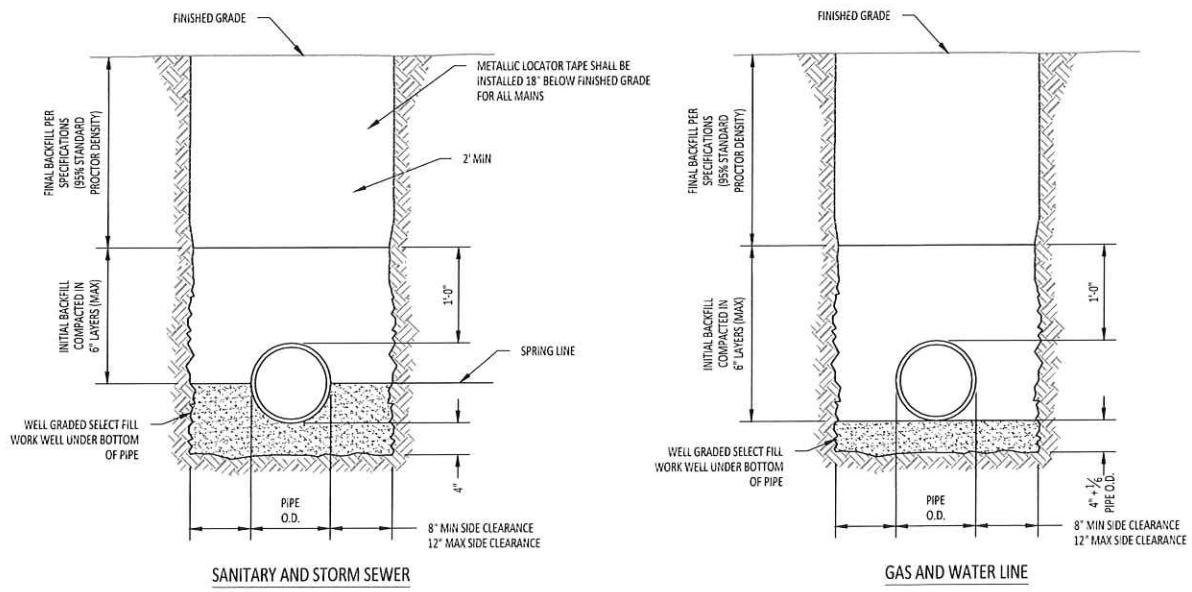

NOTE: FOR TRENCHES REQUIRING SHORING & BRACING, DIMENSIONS SHALL BE TAKEN FROM THE INSIDE FACE OF THE SHORING & BRACING.

cdfl.com
 601.366.3110
 3221 Old Canton Rd
 Suite 200
 Jackson, MS
 39216

PROJECT NUMBER 19072
DATE 11/13/2020
DRAWN BY RMC

REVISIONS	DATE
NO.	

Grace Crossing Baptist Church
Expansion
 598 Yandell Rd, Canton, MS
 39046
 Owner

NOT FOR CONSTRUCTION
Permit Set

CIVIL DETAILS

C204

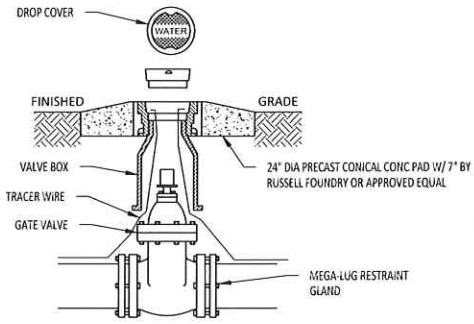

1 GATE VALVE
C205 SCALE: NOT TO SCALE

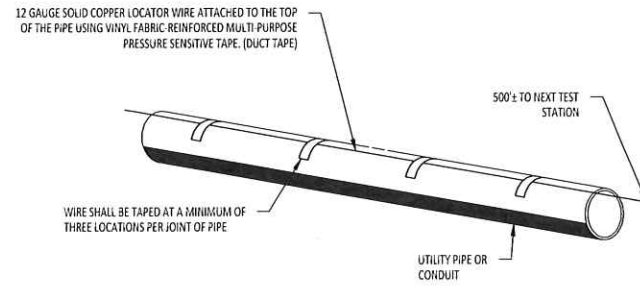

2 LOCATOR WIRE INSTALLATION
C205 SCALE: 1/2"=1'-0"

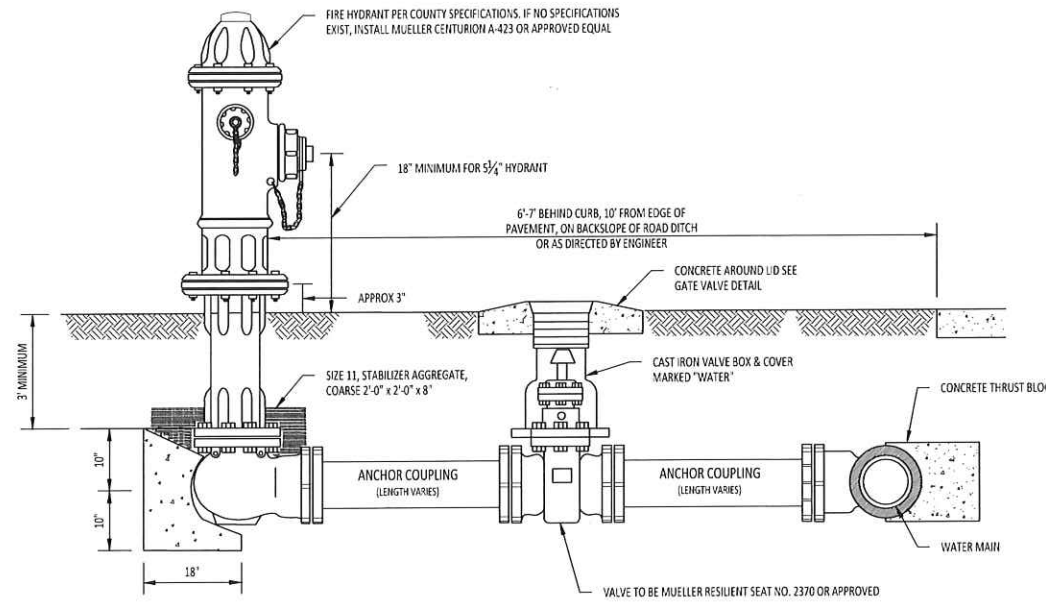

3 FIRE HYDRANT ASSEMBLY
C205 SCALE: NOT TO SCALE

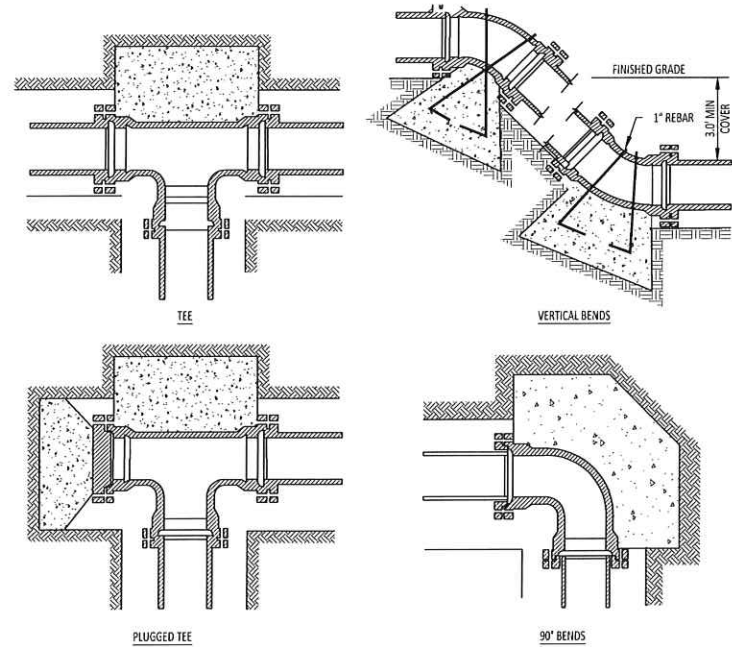

NOMINAL PIPE DIAMETER (N1)	DEAD END OR TEE	90° BEND	45° BEND	22 1/2° BEND	11 1/4° BEND
4	2.0	2.0	2.0	2.0	2.0
6	2.0	2.0	2.0	2.0	2.0
8	3.0	3.0	2.0	2.0	2.0
12	5.0	6.0	4.0	3.0	3.0
16	8.0	12.0	6.0	4.0	4.0
4	---	---	6.0 (.22)	4.0 (.15)	4.0 (.15)
6	---	---	14.0 (.52)	6.0 (.22)	4.0 (.15)
8	---	---	27.0 (1.0)	9.0 (.33)	6.0 (.22)
12	---	---	68.0 (2.5)	22.0 (.80)	9.0 (.33)
16	---	---	90. (3.33)	52.0 (1.9)	18.0 (.67)

Volume of blocks including soil load CU.FT. (CU.YDS.)

4 THRUST BLOCKS FOR WATER MAINS
C205 SCALE: 1"=1'-0"

REVISIONS	NO.	DATE

NOT FOR CONSTRUCTION
Permit Set

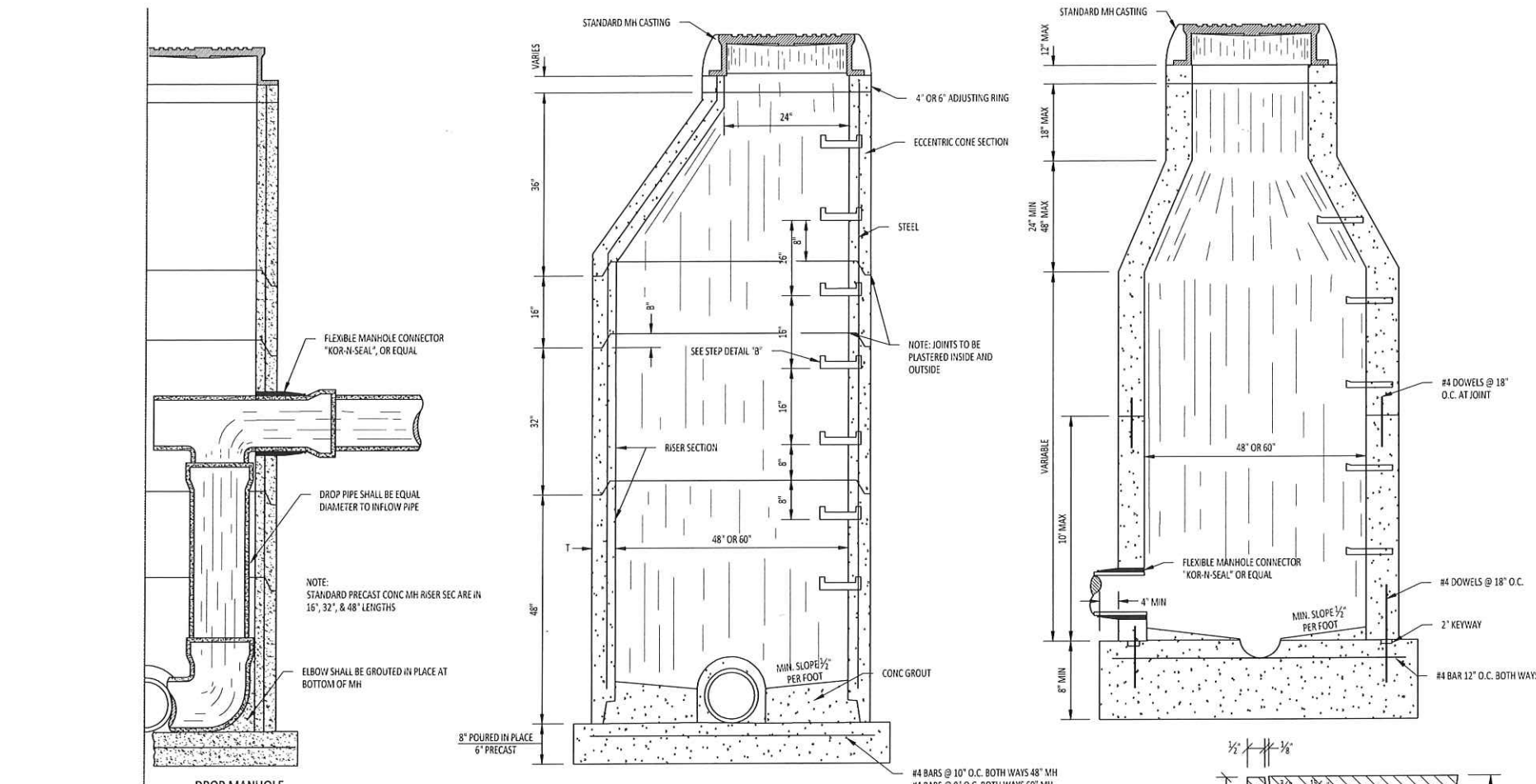

DROP MANHOLE

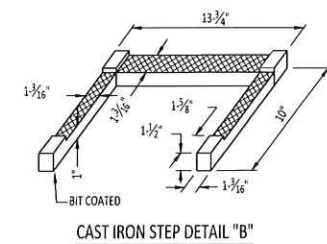

CAST IRON STEP DETAIL "B"

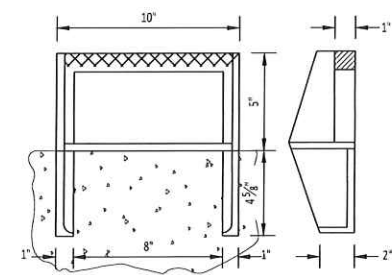

STEP DETAIL "A"



TOP PLAN OF COVER

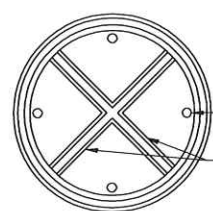

INVERT PLAN OF COVER

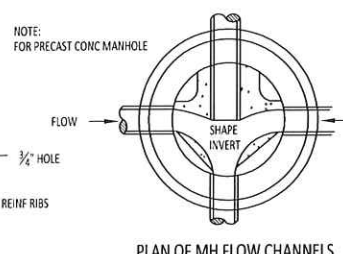

PLAN OF MH FLOW CHANNELS

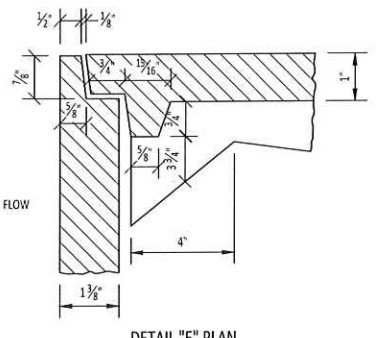

DETAIL "E" PLAN

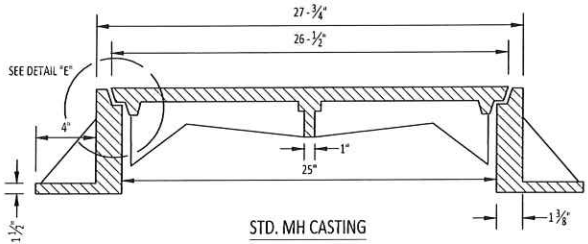

STD. MH CASTING

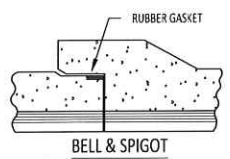

BELL & SPIGOT DETAIL "B"

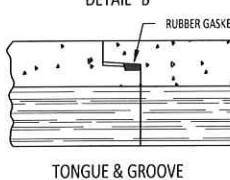

TONGUE & GROOVE

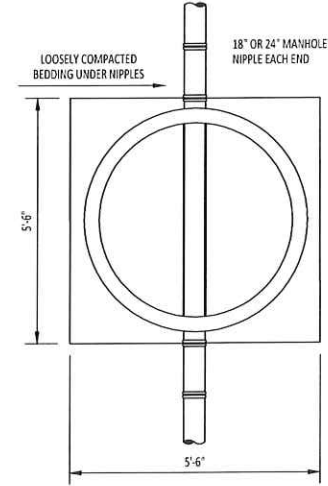

TYPICAL PIPE CONNECTION TO MANHOLE

- GENERAL NOTES
- WHERE SOIL AT THE ELEVATION OF THE BASE OF MANHOLE IS UNSUITABLE THE THICKNESS AND/OR BASE WILL BE INCREASED AS DIRECTED BY THE ENGINEER.
 - PIPE JOINTS FORMED BY JUTE AND HOT POURED BITUMINOUS COMPOUND ARE NOT PERMISSIBLE.
 - JOINTS FORMED BY RUBBER GASKET PLUS REFINED PLASTIC CEMENT COMPOUND WILL BE RECD.
 - ALL MANHOLES SHALL BE PRECAST CONCRETE MEETING THE SPECIFICATIONS FOR ASTM C478 WITH INSIDE DIMENSIONS MEETING _____ REQUIREMENTS. THE INTERIOR WALL OF MANHOLE SHALL BE COATED AT THE MANUFACTURER'S PLANT WITH A COAL TAR EPOXY COMPLYING WITH THE MANUFACTURER'S RECOMMENDATIONS. THE COATING SHALL BE A TWO-COAT LIQUID POLYMER MODIFIED HYDRAULIC WATERPROOF COATING, OR OTHER COATING SYSTEM SPECIFICALLY DESIGNED FOR THIS APPLICATION. WHEN FULLY CURED, THE TWO-COAT SYSTEM SHALL BE ABLE TO WITHSTAND A HYDRAULIC PRESSURE OF 7 OR 30 PSI RESPECTIVELY, WITHOUT ANY VISIBLE LEAKS.
 - A CONCRETE WATERPROOFING ADMIXTURE OF CEMENTITIOUS CRYSTALLINE TYPE SHALL BE ADDED TO THE CONCRETE MIX. ADMIX MATERIAL SHALL BE XYPEX ADMIN C-1000-T, OR APPROVED EQUAL, CONTAINING RED DYE TO ENSURE DETECTION IN THE CONCRETE. THE DOSAGE RATE SHALL BE 3.5% BY WEIGHT OF CEMENT. ALL APPLICATIONS SHALL BE AS RECOMMENDED BY THE MANUFACTURER. XYPEX CONCENTRATE SHALL BE APPLIED AT THE RATE OF 1.5 LBS PER SQ YD TO ALL GROUTED SURFACES IN ACCORDANCE WITH THE MANUFACTURER'S RECOMMENDATIONS.

1 SANITARY SEWER MANHOLE
C206 SCALE: NOT TO SCALE

- NOTES:
- DO NOT POUR ADDITIONAL CONCRETE ON OR BEYOND MH NIPPLE.
 - USE A MINIMUM OF 1 NIPPLE AT EACH ENTRANCE TO MH.
 - PIPE OPENING IN PRE-CAST CONCRETE UNITS SHALL BE EQUAL TO O.D. OF PIPE PLUS 6" MAXIMUM.
 - DO NOT USE BRICK, BLOCK OR TIMBER TO SUPPORT PIPE OR NIPPLES OUTSIDE OF MANHOLE.

cdfl.com
601.366.3110
3221 Old Canton Rd
Suite 200
Jackson, MS
39216

PROJECT NUMBER: 19072
DATE: 11/13/2020
DRAWN BY: RMC

REVISIONS NO.	DATE

Grace Crossing Baptist Church
Expansion
598 Yandell Rd, Canton, MS
39046
Owner

NOT FOR CONSTRUCTION
Permit Set

CIVIL DETAILS

C206

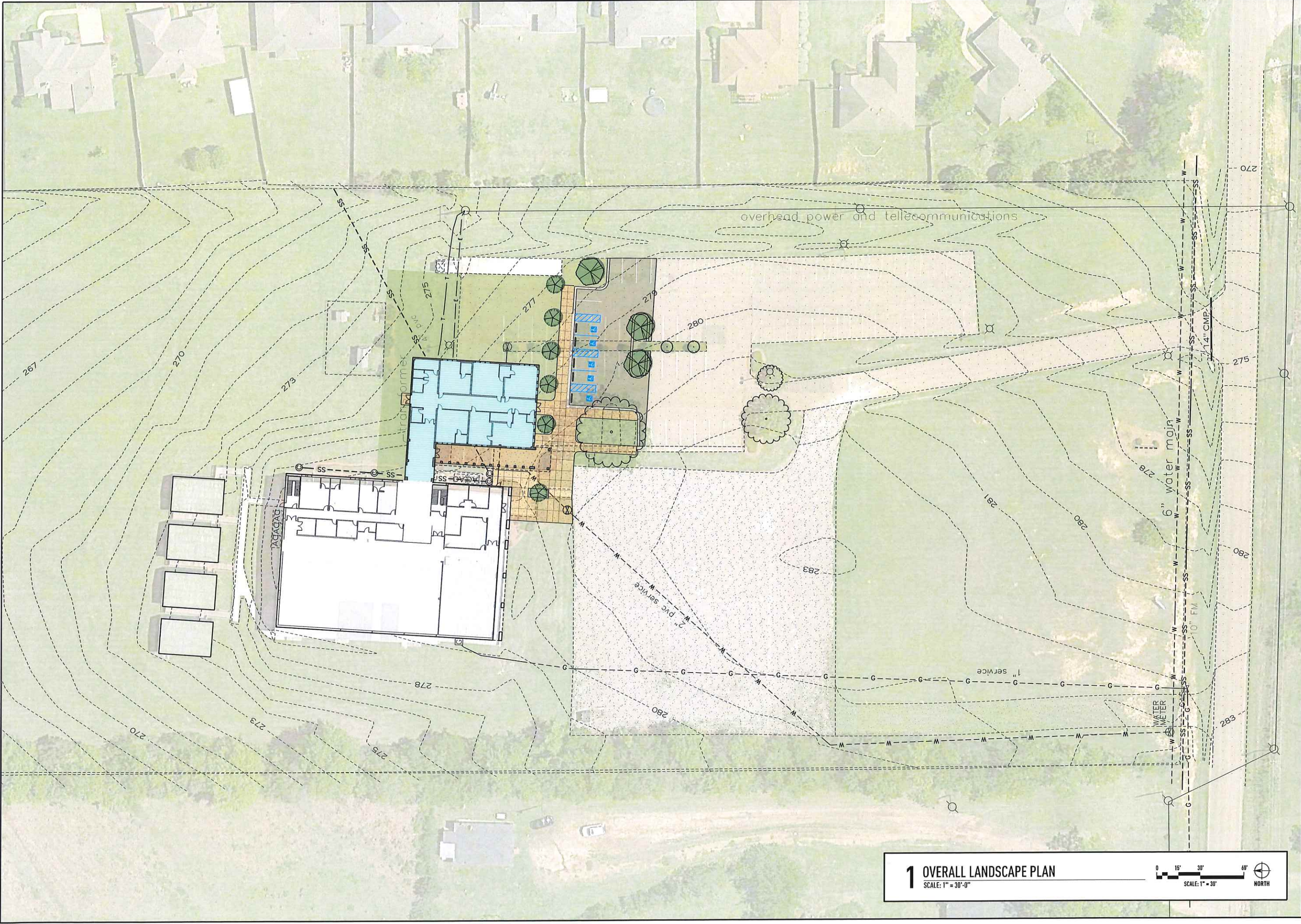

1 OVERALL LANDSCAPE PLAN
 SCALE: 1" = 30'-0"

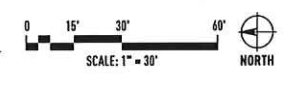

Grace Crossing Baptist Church
Expansion
 598 Yandell Rd, Canton, MS
 39046
 Grace Crossing Baptist
 Church

NOT FOR
 CONSTRUCTION

OVERALL
 LANDSCAPE PLAN

L-100

NO.	REVISION	DATE

PROJECT NUMBER
18-108

DATE
16 NOV 2020

DRAWN BY
CI-IW

CDFL
 COOKE DOUGLASS FARR LEMONS, ARCHITECTS + ENGINEERS PA

cdfl.com
 601.366.3110
 3221 Old Canton Rd
 Suite 200
 Jackson, MS
 39216



1 ENLARGED LANDSCAPE PLAN
 SCALE: 1" = 15'-0"

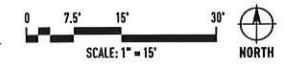

CDFL
 COOKE DOUGLASS FARR LEMONS, ARCHITECTS + ENGINEERS PA

cdfl.com
 601.366.3110
 3221 Old Canton Rd
 Suite 200
 Jackson, MS
 39216

PROJECT NUMBER	18-108
DATE	16 NOV 2020
DRAWN BY	CI-IW
REVISION	DATE
NO.	

Grace Crossing Baptist Church
Expansion
 598 Yandell Rd, Canton, MS
 39046
 Grace Crossing Baptist Church

NOT FOR CONSTRUCTION

ENLARGED LANDSCAPE PLAN
L-101

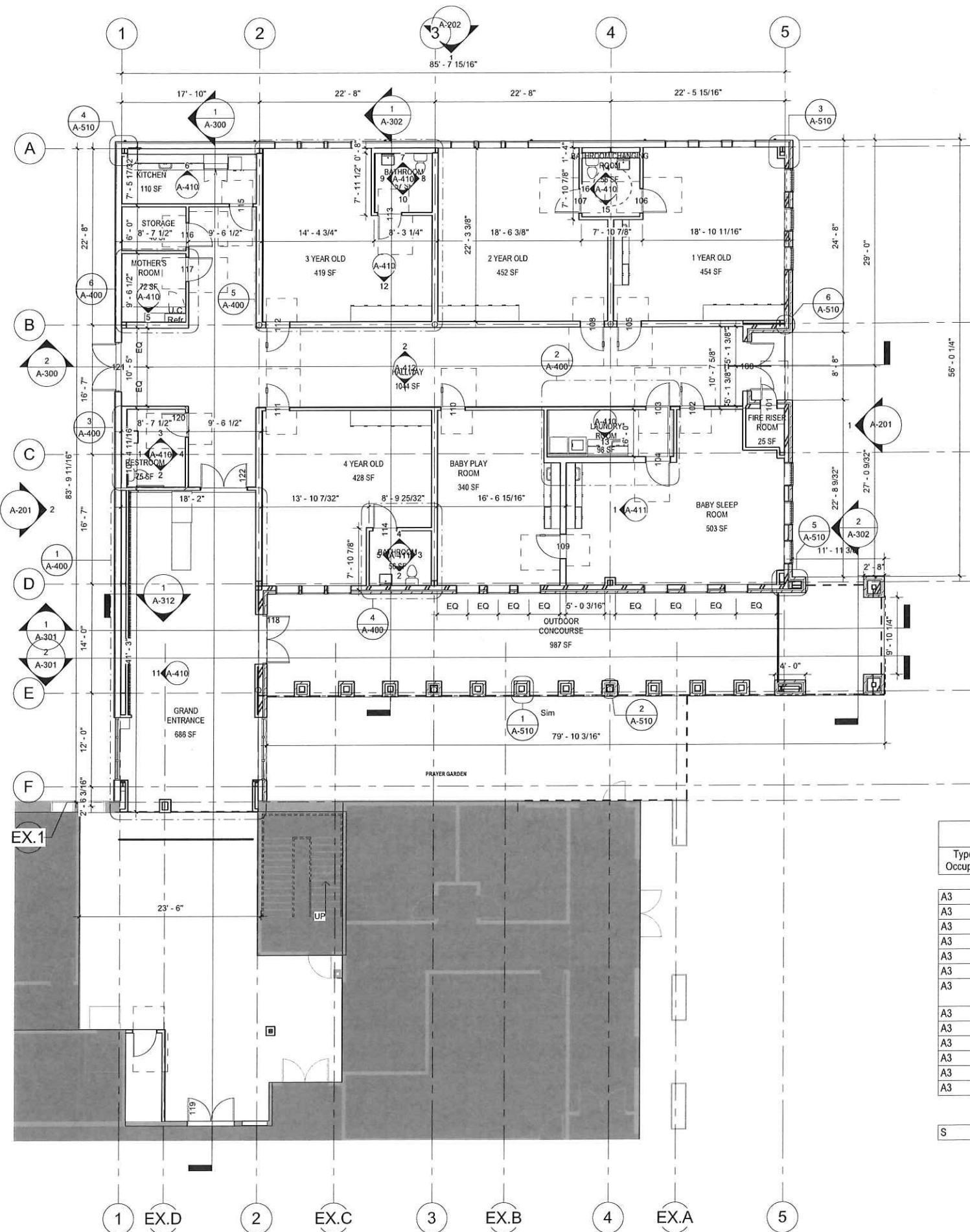

OCCUPANCY LOAD					
Type of Occupancy	Occupancy Load	Room Number	Room Name	Area	Calculated Occupancy
A3	15	23	1 YEAR OLD	454 SF	31
A3	15	5	2 YEAR OLD	452 SF	31
A3	15	25	3 YEAR OLD	419 SF	28
A3	15	72	4 YEAR OLD	428 SF	29
A3	15	76	BABY SLEEP ROOM	503 SF	34
A3	0	73	BATHROOM	56 SF	
A3	0	77	BATHROOM/CHANGING ROOM	56 SF	
A3	0	83	FIRE RISER ROOM	25 SF	
A3	15	59	GRAND ENTRANCE	686 SF	46
A3	0	82	HALLWAY	1044 SF	
A3	15	75	LAUNDRY ROOM	98 SF	7
A3	15	78	MOTHER'S ROOM	72 SF	5
A3	0	79	RESTROOM	75 SF	
				4368 SF	211
S	100	81	STORAGE	46 SF	1
				46 SF	1

GENERAL ARCHITECTURAL PLAN NOTES

- DO NOT SCALE DRAWINGS. IF DIMENSIONS ARE IN QUESTION, THE CONTRACTOR SHALL BE RESPONSIBLE FOR OBTAINING CLARIFICATION FROM THE ARCHITECT BEFORE CONTINUING WITH CONSTRUCTION.
- THE CONTRACTOR SHALL VERIFY AND COORDINATE ALL DIMENSIONS, EQUIPMENT LOCATIONS AND EXISTING CONDITIONS IN THE FIELD PRIOR TO THE START OF ANY WORK AND NOTIFY THE ARCHITECT IN WRITING OF ANY DISCREPANCIES.
- INTERIOR DIMENSIONS ARE TO THE FACE OF METAL STUD OR CONCRETE AT NEW CONSTRUCTION OR TO THE FACE OF EXISTING CONSTRUCTION UNLESS OTHERWISE NOTED (U.O.N.)
- LOCATE THE INTERIOR FACE OF ALL DOOR FRAMES 6" OFF ADJACENT WALL, U.O.N.
- LOCATE THE FACE OF ALL INTERIOR WALLS PERPENDICULAR TO EXTERIOR WALLS 6" OFF THE ADJACENT WINDOW, U.O.N.
- ALL COLUMNS ARE TO FURRED OUT WITH 1 5/8" METAL STUDS. LOCATE THE FACE OF STUD 2" FROM THE FACE OF THE COLUMN, U.O.N. REFER TO PARTITION TYPES AND PLAN DETAILS FOR ADDITIONAL INFORMATION.
- REFER TO SHEET A500 FOR TYPICAL PENETRATION DETAILS.
- REFER TO SHEET A501 FOR WALL PARTITION TYPES.
- PROVIDE 18" CLEAR ON THE PULL SIDE AND 12" CLEAR ON THE PUSH SIDE OF ALL DOORS PER THE AMERICANS WITH DISABILITIES ACT.
- CONTRACTOR TO PROVIDE WOOD OR METAL BLOCKING AS REQUIRED FOR MILLWORK, ACCESSORIES, EQUIPMENT, ETC. COORDINATE WITH PLANS AND ELEVATIONS.

SYMBOLS and DRAWING CONVENTIONS

- 101 DOORS: REFER TO DOOR SCHEDULE SHEET A601 & A602
- A WINDOWS: REFER TO WINDOW SCHEDULE SHEET A602
- 1 INTERIOR PARTITION TYPES: REFER TO SHEET A602
- REFERENCE LABEL: 1 SIM SECTION MARK
- DETAIL NUMBER: 1 SIM
- SHEET NUMBER: A101 ENLARGED PLAN
- SIM 1 A-101
- SHEET NUMBER: 1 A101 1 INTERIOR ELEVATION
- ELEVATION NUMBER(S): 1
- REVISION MARK: CLOUD
- REVISION NUMBER: 1
- ROOM NAME: 101 150 SF ROOM NAME, NUMBER AND SQUARE FEET



cdfl.com
601.366.3110
3221 Old Canton Rd
Suite 200
Jackson, MS
39216

PROJECT NUMBER	DATE	DRAWN BY
18-108	11/16/20	Author

Grace Crossing Baptist Church
Expansion
598 Yandell Rd, Canton, MS
39046
Grace Crossing Baptist Church

NOT FOR CONSTRUCTION
SITE PLAN REVIEW

FIRST FLOOR PLAN

A-111

1 FIRST FLOOR PLAN
1/8" = 1'-0"

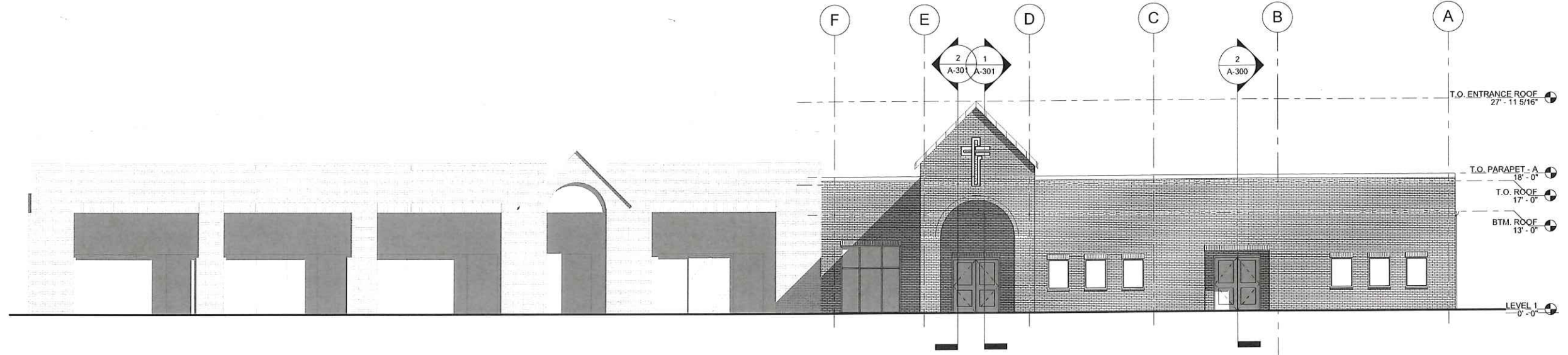

1 Overall Elevation - Front
1/8" = 1'-0"

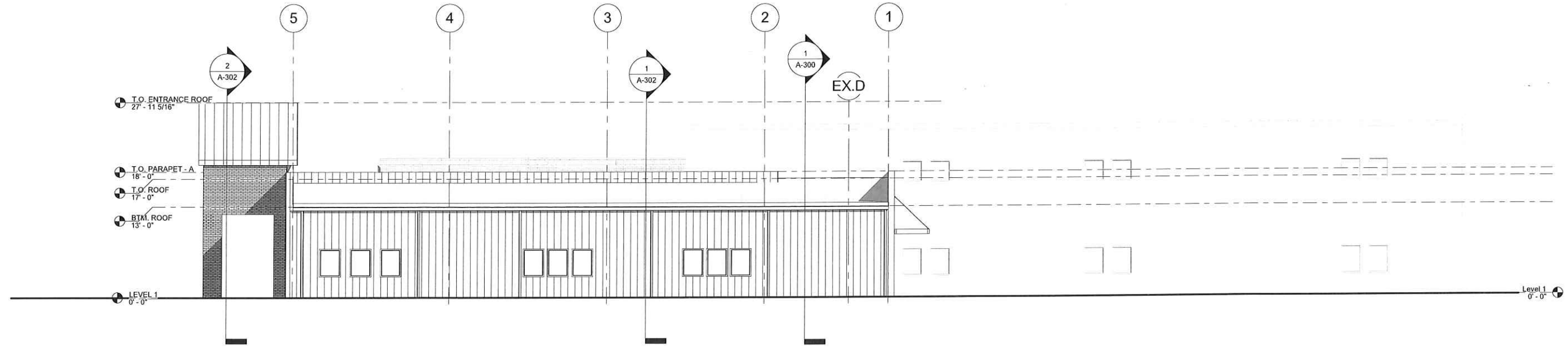

2 Overall Elevation - East
1/8" = 1'-0"

REVISIONS	NO.	DATE

**NOT FOR
CONSTRUCTION
SITE PLAN
REVIEW**

MASTER EXTERIOR
ELEVATIONS

A-200

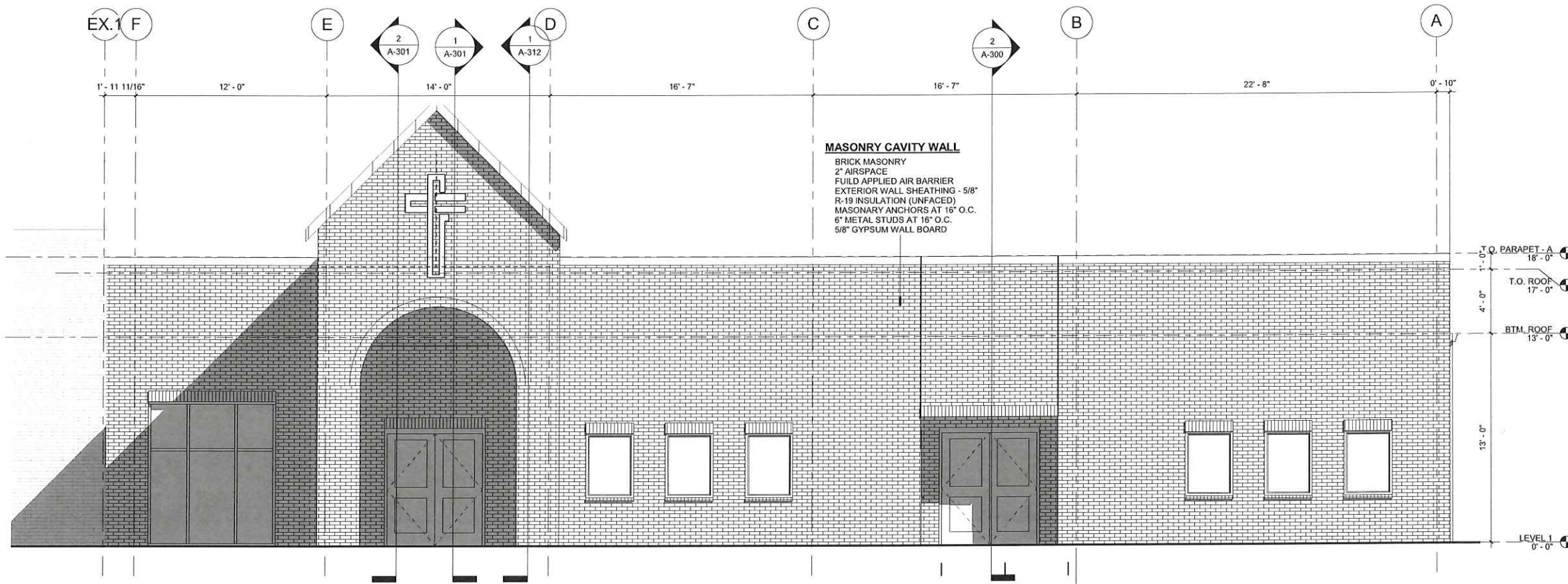

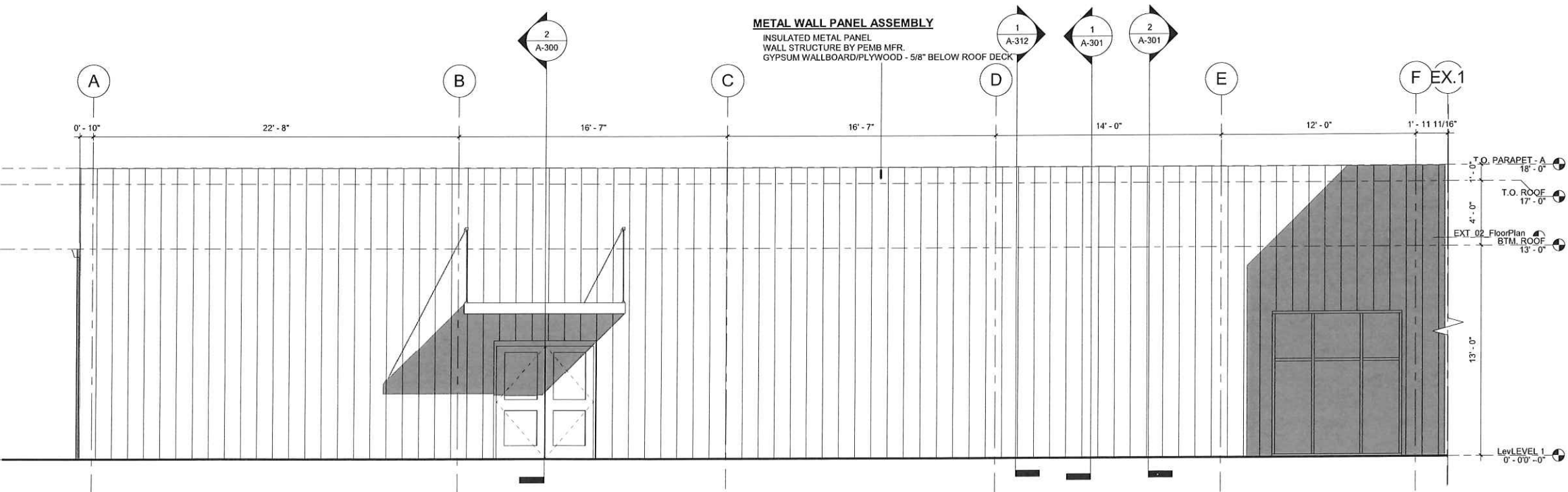

MASONRY CAVITY WALL
 BRICK MASONRY
 2" AIRSPACE
 FLUID APPLIED AIR BARRIER
 EXTERIOR WALL SHEATHING - 5/8"
 R-19 INSULATION (UNFACED)
 MASONRY ANCHORS AT 16" O.C.
 6" METAL STUDS AT 16" O.C.
 5/8" GYPSUM WALL BOARD

1 Elevation - Front
 1/4" = 1'-0"

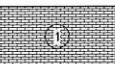

METAL WALL PANEL ASSEMBLY
 INSULATED METAL PANEL
 WALL STRUCTURE BY PEMB MFR.
 GYPSUM WALLBOARD/PLYWOOD - 5/8" BELOW ROOF DECK

2 Elevation - Back
 1/4" = 1'-0"

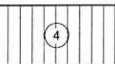
-  STANDARD BRICK -
RUNNING BOND
MATCH EXISTING
BRICK COLOR
-  STANDARD BRICK -
SOILER BOND
-  METAL PANELS -
HORIZONTAL RIBS - MATCH
EXISTING
-  STANDING SEAM
METAL ROOF

PROJECT NUMBER		DATE		DRAWN BY	
18-108		11/16/20		REF	
NO.	DATE				

Grace Crossing Baptist Church
 Expansion
 588 Yandell Rd, Canton, MS
 39046
 Grace Crossing Baptist
 Church



**NOT FOR
 CONSTRUCTION
 SITE PLAN
 REVIEW**

EXTERIOR
 ELEVATIONS

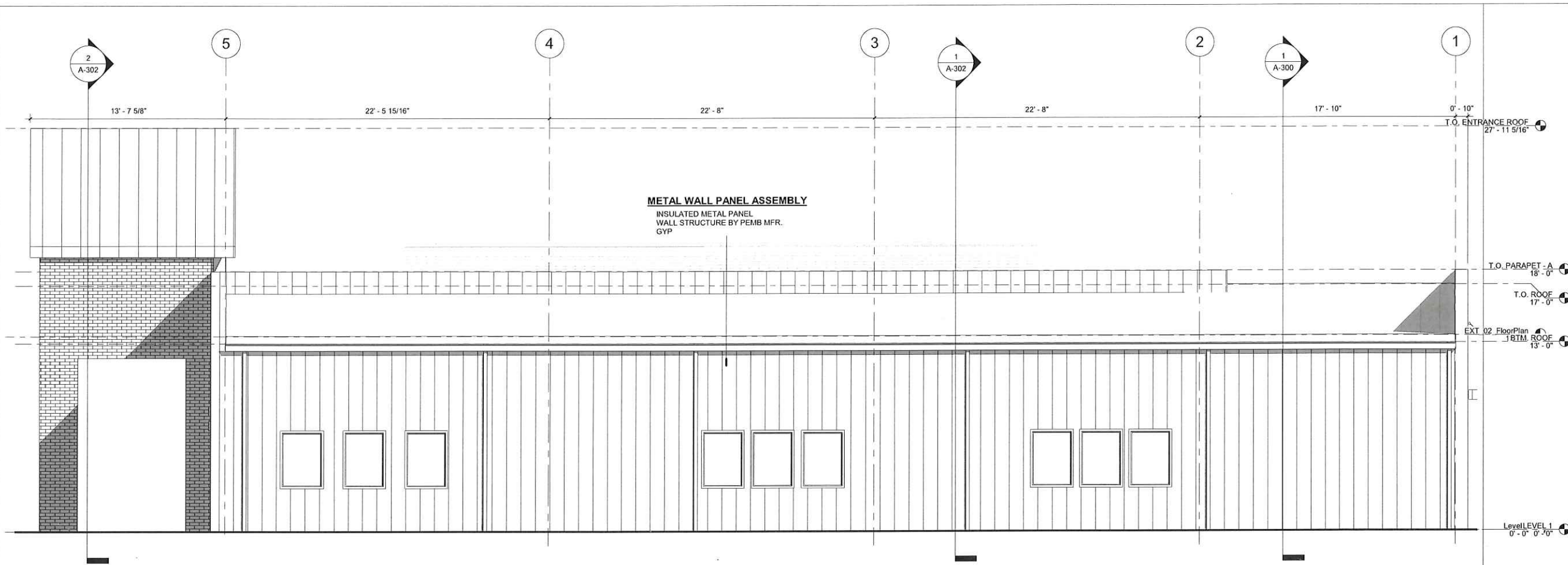
A-201

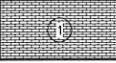

1 Elevation - East
1/4" = 1'-0"

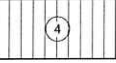
-  STANDARD BRICK -
RUNNING BOND
MATCH EXISTING
BRICK COLOR
-  STANDARD BRICK -
SOILER BOND
-  METAL PANELS -
HORIZONTAL RIBS - MATCH
EXISTING
-  STANDING SEAM
METAL ROOF

cdfl.com
601.366.3110
3221 Old Canton Rd
Suite 200
Jackson, MS
39216

REVISIONS		PROJECT NUMBER	DATE	DRAWN BY	REF
NO.	DATE	18-108	11/16/20		

**Grace Crossing Baptist Church
Expansion**
588 Yandell Rd, Canton, MS
39046
Grace Crossing Baptist
Church

**NOT FOR
CONSTRUCTION
SITE PLAN
REVIEW**

EXTERIOR
ELEVATIONS

A-202